

DELAWARE AVENUE (40' R.O.W)

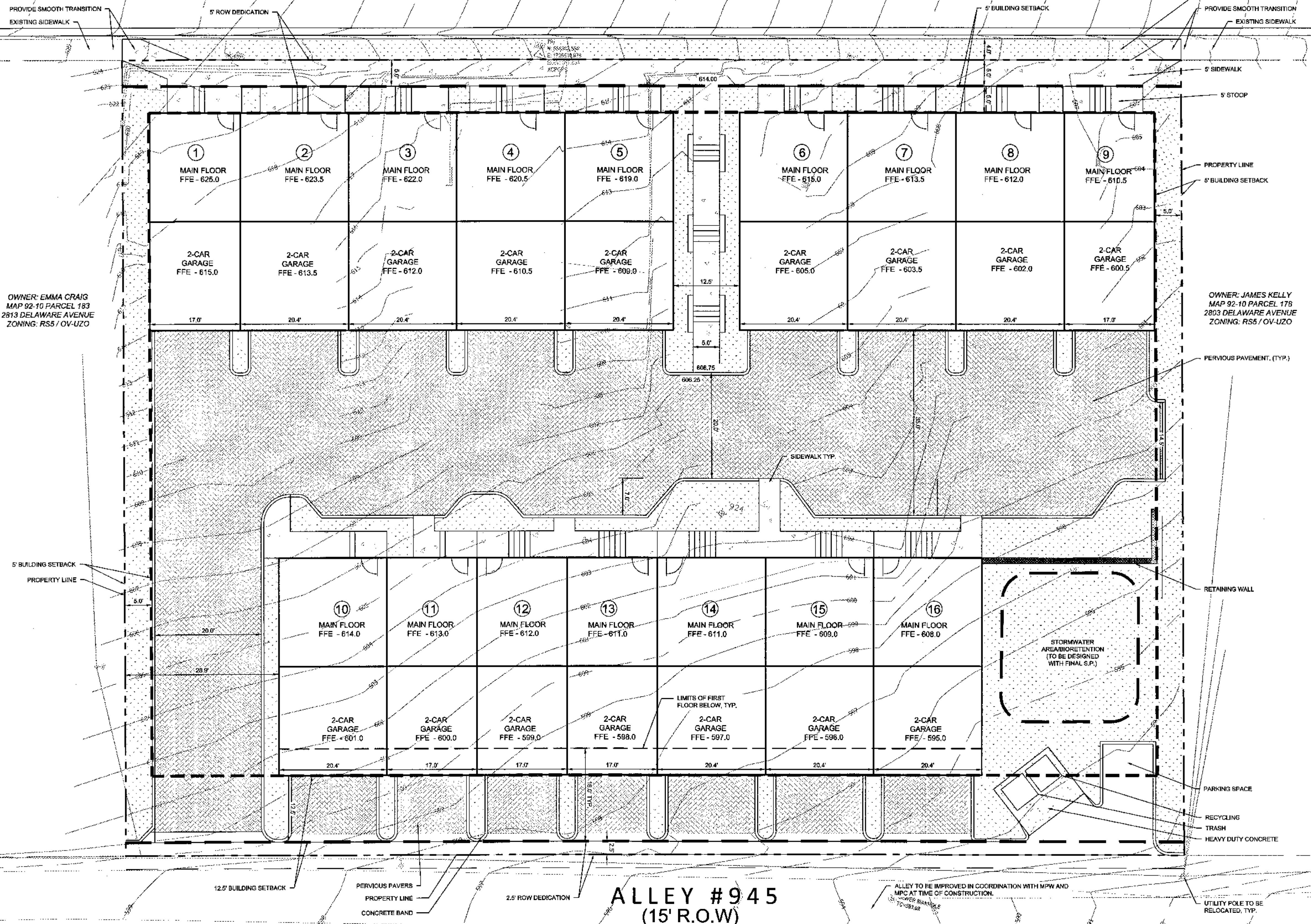

OWNER: EMMA CRAIG
MAP 92-10 PARCEL 183
2813 DELAWARE AVENUE
ZONING: RS5 / OV-UZO

OWNER: JAMES KELLY
MAP 92-10 PARCEL 178
2803 DELAWARE AVENUE
ZONING: RS5 / OV-UZO

ALLEY #945 (15' R.O.W)

ALLEY TO BE IMPROVED IN COORDINATION WITH MPW AND MPC AT TIME OF CONSTRUCTION.

UTILITY POLE TO BE RELOCATED, TYP.