

CAUTION
 THE POSITION OF THE WATER AND SANITARY SEWER MAINS SHOWN ARE APPROXIMATE AND ARE INTENDED TO SHOW THE GENERAL LOCATION ONLY. THE SIZES NOTED ARE TO THE BEST OF MWS KNOWLEDGE. IN ALL CASES WHERE PRECISE LOCATION AND MAIN SIZES ARE REQUIRED, FIELD VERIFICATION WILL BE NECESSARY.

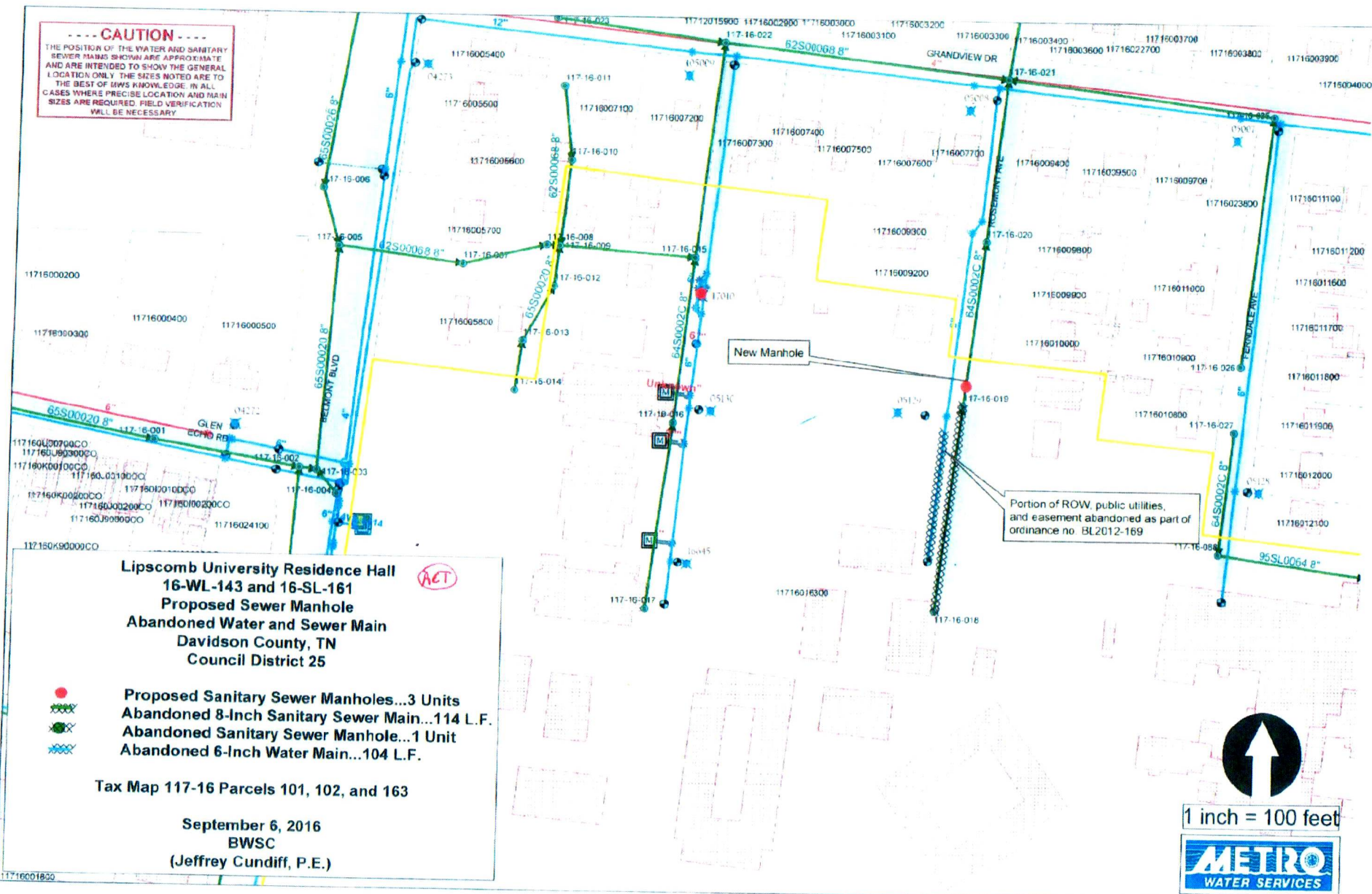

Lipscomb University Residence Hall
 16-WL-143 and 16-SL-161
 Proposed Sewer Manhole
 Abandoned Water and Sewer Main
 Davidson County, TN
 Council District 25

ACT

- Proposed Sanitary Sewer Manholes...3 Units
- XXXX Abandoned 8-Inch Sanitary Sewer Main...114 L.F.
- XX Abandoned Sanitary Sewer Manhole...1 Unit
- XXXX Abandoned 6-Inch Water Main...104 L.F.

Tax Map 117-16 Parcels 101, 102, and 163

September 6, 2016
 BWSC
 (Jeffrey Cundiff, P.E.)

New Manhole

Portion of ROW, public utilities, and easement abandoned as part of ordinance no. BL2012-169



1 inch = 100 feet

