

NOTE:
LOCATIONS OF
EXISTING UTILITIES
ARE APPROXIMATE.

SCALE
HORIZONTAL: 1" = 20'
VERTICAL: 1" = 2'

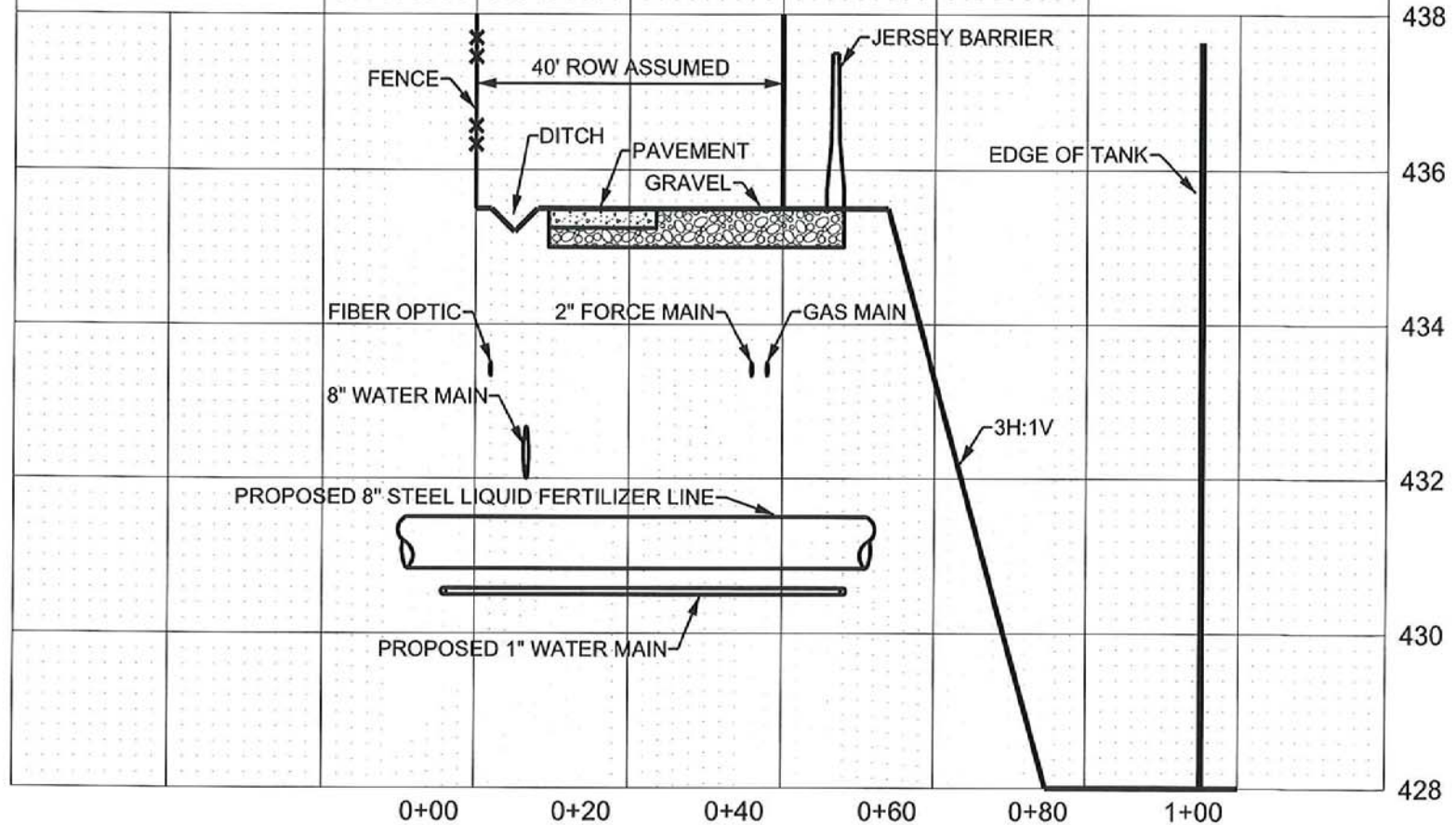

SECTION A-A

**ENCROACHMENT FOR
HUNTER MARINE TANK FARM
6615 ROBERTSON AVE.
LIQUID FERTILIZER
7-27-15**

BWSC | BARGE
WAGGONER
SUMNER &
CANNON, INC.

211 Commerce Street, Suite 600, Nashville, Tennessee 37204
PHONE (615) 254-1000 FAX (615) 250-6372

Copyright 2010, Barge Waggoner Sumner & Cannon, Inc. All Rights Reserved