

Proposal Number 2017M-009AB-001
Map: 117-1
Council District #24

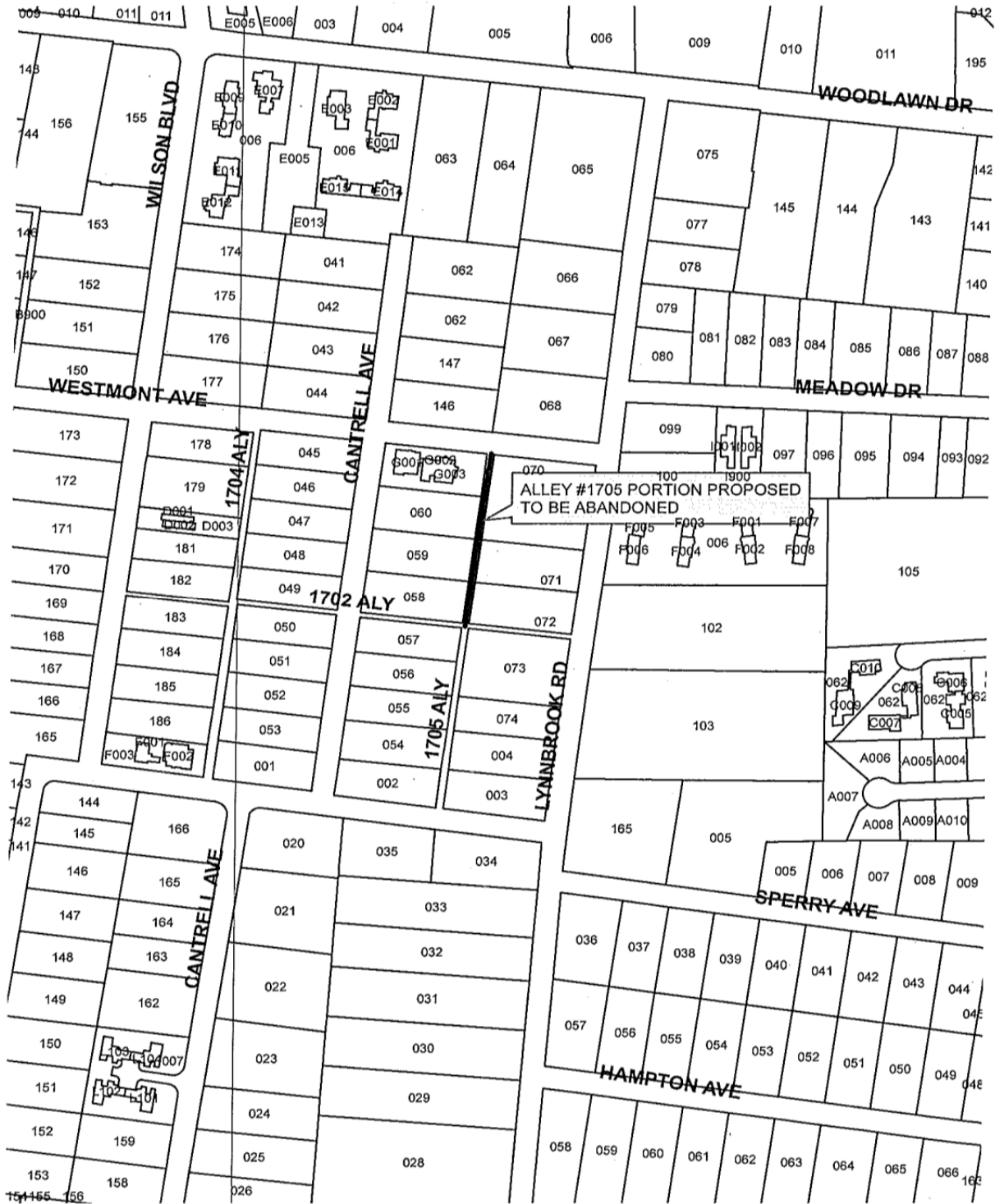

Metropolitan Government Department of Public Works

750 South 5th Street ♦ Nashville, TN 37206 ♦ (615) 862-8750 ♦ www.nashville.gov/gw

Mandatory Referral Application: Street / Alley Closure

*** Before filing this application, please review checklist on the back of this application. ***

Mandatory Referral Project No. _____
(MPW staff assigns project #)

Date Submitted: _____

Closure Type:

- Street
 Alley

Easements:

- Retain utilities
 Abandon utilities & relocate at applicant's expense

Street/Alley Location:

Alley 1705
Street Name(s) / Alley Number(s)
From Westmont Ave to Alley 1702 between Lynbrook Rd. and Cantrell Ave
Street / Alley Located Between?

Reason for Closure:

Not an improved right of way and not in use

Applicant: All correspondence will be mailed to the applicant.

Architect Engineer Property Owner Other: _____

Name: Alex Wadley

Business: _____

Address: 703 Lynbrook Rd

City: Nashville State: TN Zip: 37215

Phone: 615-400-4881
business home business mobile

Fax: _____
business home business mobile

E-mail: awadley@yahoo.com

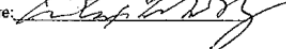
Applicant's Signature: 

Filing Fee (All application fees are non-refundable)

Street / Alley Closure \$300.00

Amount paid \$300

Accepted by: 

Date: 2/20/17

SIGNATURE(S)

(copy this sheet if needed for additional signatures)

As the owner(s) of property, I/we agree to the submission of this mandatory referral application to the Metropolitan Government Department of Public Works for a street and/or alley closure. We live adjacent to this street/alley and/or we consider ourselves an affected property owner.

Printed Name & Signature (required)	Address	Phone #	Map	Parcel
<i>Cathy Breland</i> Edward Breland et ux	705 Lynbrooke Rd	615-269-9855	117-1	71
<i>J. Dale IV</i> Allan Dale IV Tiffany Dale IV	707 Lynbrooke Rd	615-533-4590	117-1	72
<i>as trustee</i> Deborah (Doris) Deborah G Dawes Living Trust	706 Cantrell Ave	615-297-3297	117-1	58
<i>W. Marie + Heather V. Schaefer</i>	704 Cantrell Ave	615-289-1425	117-1	59
<i>John Charles Randolph Farmer</i>	702 Cantrell Ave	615-310-4354	117-1	60
<i>Sol A. Probus</i> Andrey R. Carvajal	700 Cantrell Ave	615-479-1520	117-1-G	1
<i>Nancy V. Bailey</i> Nancy V. Bailey	3709 Westmont Ave.	615-308-9287	117-1-G	2