

Exhibit 1



WEST RIVER FRONT PARK
48-INCH COMBINATION SEWER REPLACEMENT
MWS 14-SWC-0018

ABANDONMENT OF APPROXIMATELY 125 LF OF 48-INCH COMBINATION SEWER MAIN & EASEMENT
ACCEPTANCE OF APPROXIMATELY 215 LF OF 48-INCH COMBINATION SEWER MAIN & EASEMENT

JANUARY 21, 2015 CDM19 MAP 93-07 PARCELS 35 & 36

CIVIC ENGINEERING

EXHIBIT "A"
EASEMENT ABANDONMENT EXHIBIT FOR
210 & 310 FIRST AVENUE SOUTH
METRO GOVERNMENT PROPERTY
SCALE: 1" = 100' DATE: 1-15-2015



25 LINDSLEY AVENUE
NASHVILLE, TENNESSEE 37210
(615) 425-2000

NOTE:
A COMPLETE BOUNDARY SURVEY WAS NOT PERFORMED BY CIVIC ENGINEERING FOR THE PURPOSE OF THIS EXHIBIT. THIS EXHIBIT WAS DONE UNDER THE AUTHORITY OF T.C.A. 62-18-126 AND THIS EXHIBIT IS NOT A GENERAL PROPERTY SURVEY AS DEFINED UNDER RULE 0820-3-07.

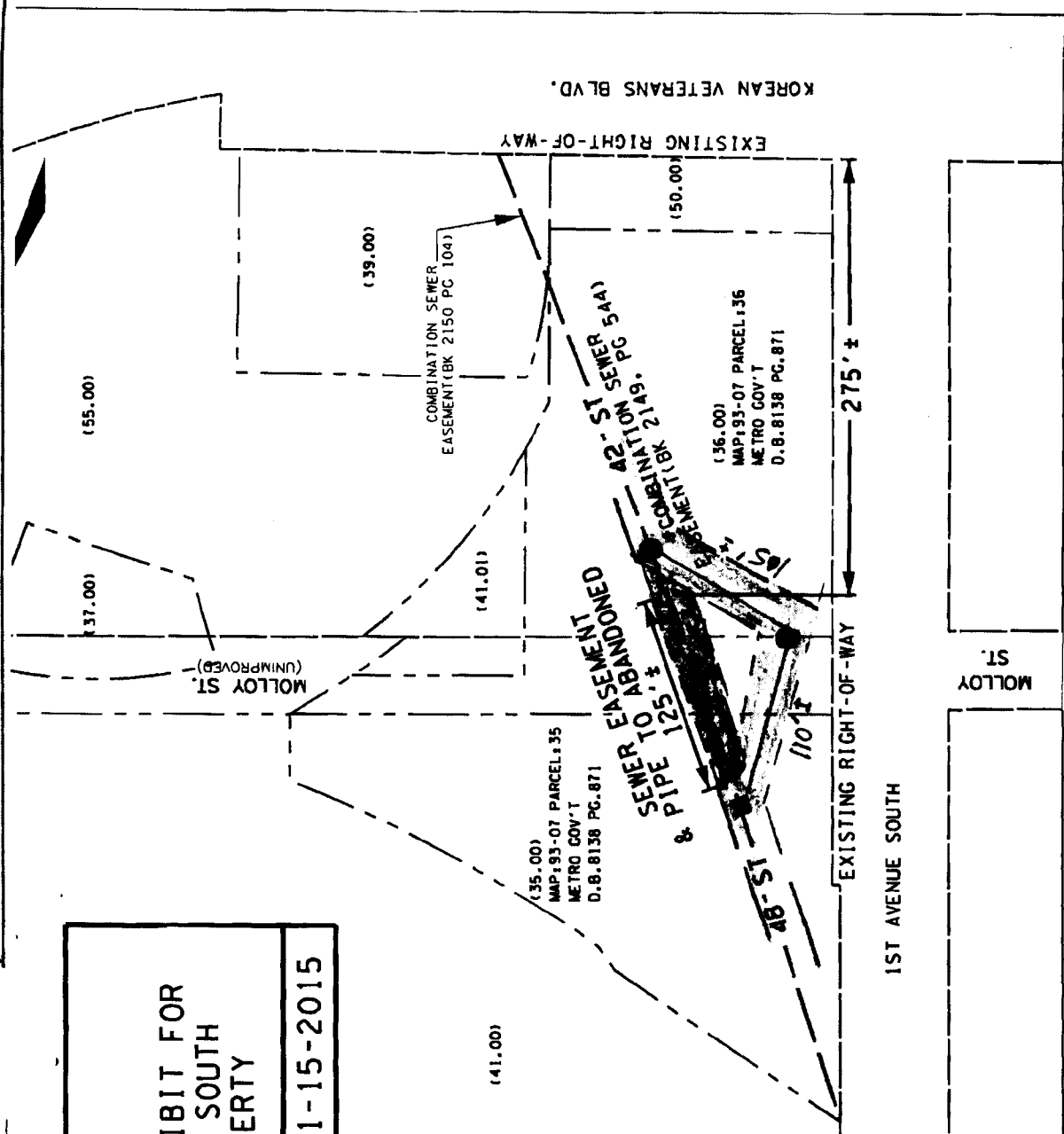

DEMOMBREUN ST

MOLLOY ST

1ST AVENUE SOUTH

KOREAN VETERANS BLVD.

EXISTING RIGHT-OF-WAY

275' ±

EXISTING RIGHT-OF-WAY

(41.00)

(35.00)
MAP: 93-07 PARCEL: 35
METRO GOV'T
D.B. 8138 PG. 871

(36.00)
MAP: 93-07 PARCEL: 36
METRO GOV'T
D.B. 8138 PG. 871

(39.00)

(55.00)

(37.00)

(41.01)

MOLLOY ST
(UNIMPROVED)

COMBINATION SEWER
EASEMENT (BK 2150 PG 104)

SEWER EASEMENT
& PIPE 125' ±
ABANDONED
42 ST SEWER 5AA
COMBINATION BK 2150 PG 104

48 ST
110 ST