

ABANDON EXISTING 6-INCH WM  
CUT AND CAP AT TEE IN 12TH AVE S  
CUT AND CAP IN WADE AVE

12TH AVE S AT WEDGEWOOD AVE  
6-INCH WATER MAIN ABANDONMENT  
8-INCH SANITARY SEWER ABANDONMENT  
MWS PROJECT NUMBER: 16WG0077 & 16SG0250  
COUNCIL DISTRICT 17  
PARCEL 10509011800

ABANDON 6-INCH WATER MAIN = 190 LF  
ABANDON 8-INCH SANITARY SEWER = 250 LF  
ABANDON SANITARY SEWER MANHOLES = 4 UNITS

Abandon any associated easements  
Proposed Sanitary Sewer Manhole = 1 Unit

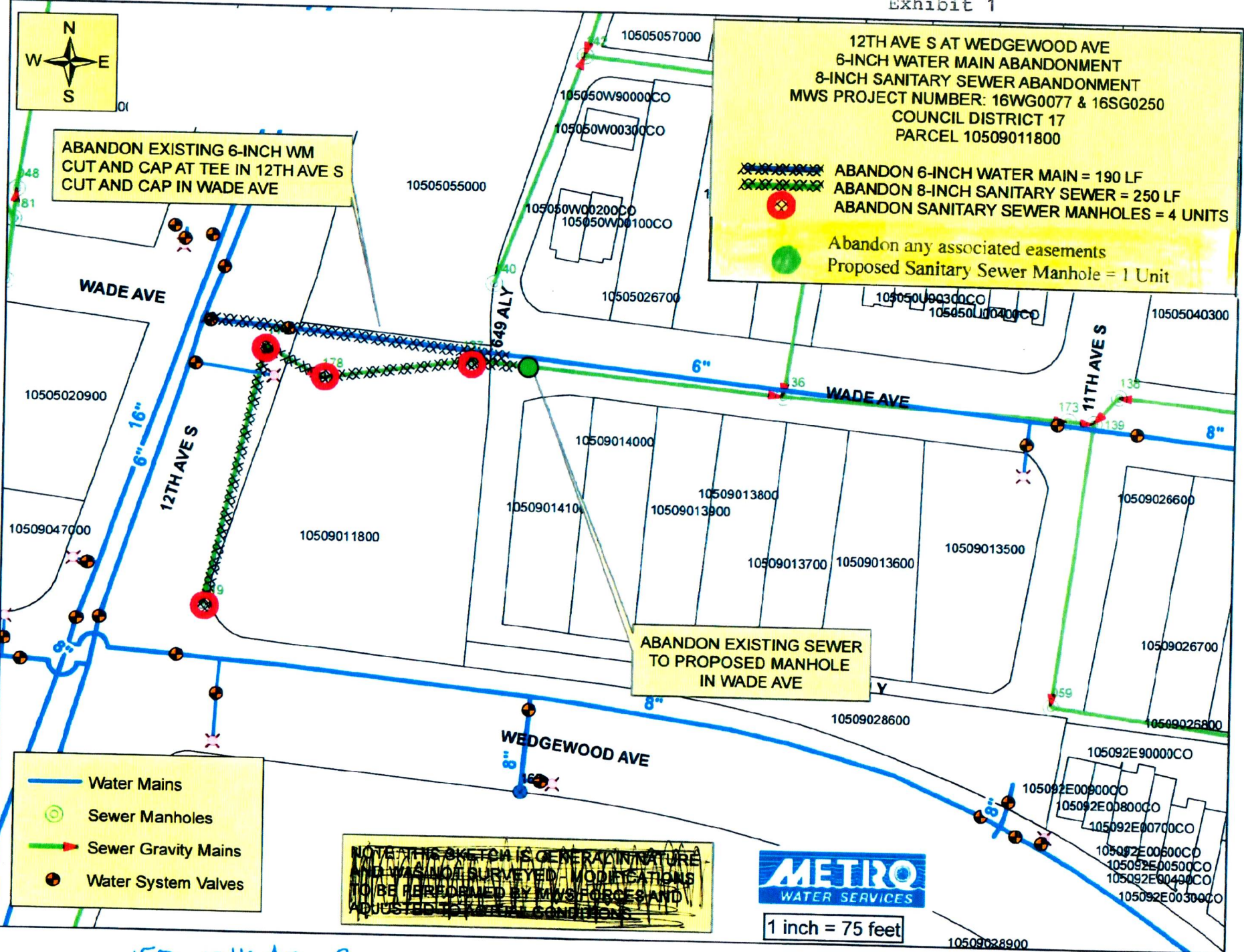

- Water Mains
- Sewer Manholes
- Sewer Gravity Mains
- Water System Valves

NOTE: THIS SKETCH IS GENERAL IN NATURE  
AND WAS NOT SURVEYED. MODIFICATIONS  
TO BE PERFORMED BY MWS FORCES AND  
ADJUSTED TO FIELD CONDITIONS.



1 inch = 75 feet

1500 12th Ave S