

Proposal No. 2016M-031EN-001

ACORD		CERTIFICATE OF LIABILITY INSURANCE		DATE (MMDDYYYY) 8/18/2016		
THIS CERTIFICATE IS ISSUED AS A MATTER OF INFORMATION ONLY AND CONFERS NO RIGHTS UPON THE CERTIFICATE HOLDER. THIS CERTIFICATE DOES NOT AFFIRMATIVELY OR NEGATIVELY AMEND, EXTEND OR ALTER THE COVERAGE AFFORDED BY THE POLICIES BELOW. THIS CERTIFICATE OF INSURANCE DOES NOT CONSTITUTE A CONTRACT BETWEEN THE ISSUING INSURER(S), AUTHORIZED REPRESENTATIVE OR PRODUCER, AND THE CERTIFICATE HOLDER.						
IMPORTANT: If the certificate holder is an ADDITIONAL INSURED, the policy(ies) must be endorsed. If SUBROGATION IS WAIVED, subject to the terms and conditions of the policy, certain policies may require an endorsement. A statement on this certificate does not confer rights to the certificate holder in lieu of such endorsement(s).						
PRODUCER Alliant Insurance Services, Inc. 701 B St 6th Flr San Diego CA 92101		CONTACT NAME: Jessica Bratz PHONE (AC, Ho, Fax): 619-849-3818 FAX (AC, Ho): 619-599-2104 EMAIL: jbratz@alliant.com ADDRESS: jbratz@alliant.com				
INSURED GOODTIM-01 CJS-Nashville, LLC DBA Cervesa Jack's c/o Good Time Design, LLC 715 J St #206 San Diego CA 92101		INSURER(S) AFFORDING COVERAGE NAIC # INSURER A: Ohio Security Insurance Company 24082 INSURER B: Ohio Casualty Insurance Company 24074 INSURER C: INSURER D: INSURER E: INSURER F:				
COVERAGES CERTIFICATE NUMBER: 29262206 REVISION NUMBER:						
THIS IS TO CERTIFY THAT THE POLICIES OF INSURANCE LISTED BELOW HAVE BEEN ISSUED TO THE INSURED NAMED ABOVE FOR THE POLICY PERIOD INDICATED. NOTWITHSTANDING ANY REQUIREMENT, TERM OR CONDITION OF ANY CONTRACT OR OTHER DOCUMENT WITH RESPECT TO WHICH THIS CERTIFICATE MAY BE ISSUED OR MAY PERTAIN, THE INSURANCE AFFORDED BY THE POLICIES DESCRIBED HEREIN IS SUBJECT TO ALL THE TERMS, EXCLUSIONS AND CONDITIONS OF SUCH POLICIES. LIMITS SHOWN MAY HAVE BEEN REDUCED BY PAID CLAIMS.						
POLICY LINE	TYPE OF INSURANCE	ADDITIONAL INSURED (IND. VEH.)	POLICY NUMBER	POLICY EFF. DATE (MMDDYYYY)	POLICY EXP. DATE (MMDDYYYY)	LIMITS
A	COMMERCIAL GENERAL LIABILITY <input type="checkbox"/> CLAIMS-MADE <input type="checkbox"/> OCCUR GEN'L AGGREGATE LIMIT APPLIES PER: <input type="checkbox"/> POLICY <input type="checkbox"/> PROJ. <input type="checkbox"/> LOC <input type="checkbox"/> OTHER	Y	BKS57497587	8/15/2016	8/15/2017	EACH OCCURRENCE \$1,000,000 DAMAGE TO RENTED PERMITS (A, B, C, D, E, F, G, H, I, J, K, L, M, N, O, P, Q, R, S, T, U, V, W, X, Y, Z) \$500,000 MED EXP (Any one person) \$ PERSONAL & ADV INJURY \$1,000,000 GENERAL AGGREGATE \$2,000,000 PRODUCTS - COM/OP AGG \$2,000,000 \$
A	AUTOMOBILE LIABILITY <input type="checkbox"/> ANY AUTO <input type="checkbox"/> ALL OWNED AUTOS <input type="checkbox"/> SCHEDULED AUTOS <input checked="" type="checkbox"/> HIRED AUTOS <input checked="" type="checkbox"/> NON-OWNED AUTOS		BAS57497587	8/15/2016	8/15/2017	COMBINED SINGLE LIMIT (Per accident) \$1,000,000 BODILY INJURY (Per person) \$ BODILY INJURY (Per accident) \$ PROPERTY DAMAGE (Per accident) \$ \$
B	UMBRELLA LIAB <input checked="" type="checkbox"/> OCCUR <input checked="" type="checkbox"/> EXCESS LIAB <input type="checkbox"/> CLAIMS-MADE CRO RETENTION'S		ESO57497587	8/15/2016	8/15/2017	EACH OCCURRENCE \$1,000,000 AGGREGATE \$1,000,000 \$
WORKERS COMPENSATION AND EMPLOYERS' LIABILITY ANY PROPRIETOR/PARTNER/EXECUTIVE OFFICER/INSURER EXCLUDED? (Mandatory in NH) If yes, describe under DESCRIPTION OF OPERATIONS below		Y/N	N/A			PER STATUTE STATE OTHER RR E.L. EACH ACCIDENT \$ E.L. DISEASE - EA EMPLOYEE \$ E.L. DISEASE - POLICY LIMIT \$
DESCRIPTION OF OPERATIONS / LOCATIONS / VEHICLES (ACORD 101, Additional Remarks Schedule, may be attached if more space is required) Re: Sign for CJS-Nashville, LLC at 135 2nd Ave N, Nashville, TN 37201 The Metropolitan Government of Nashville & Davidson County, Metro Legal and Claims, c/o Insurance and Safety Division is Additional Insured as respects operations of Named Insured as required by written contract. 30 day notice of cancellation applies.						
CERTIFICATE HOLDER				CANCELLATION		
The Metropolitan Government of Nashville & Davidson County Metro Legal and Claims c/o Insurance and Safety Division 222 Third Ave N Ste 501 Nashville TN 37201				SHOULD ANY OF THE ABOVE DESCRIBED POLICIES BE CANCELLED BEFORE THE EXPIRATION DATE THEREOF, NOTICE WILL BE DELIVERED IN ACCORDANCE WITH THE POLICY PROVISIONS. AUTHORIZED REPRESENTATIVE 		

ACORD 25 (2014/01)

The ACORD name and logo are registered marks of ACORD

© 1988-2014 ACORD CORPORATION. All rights reserved.

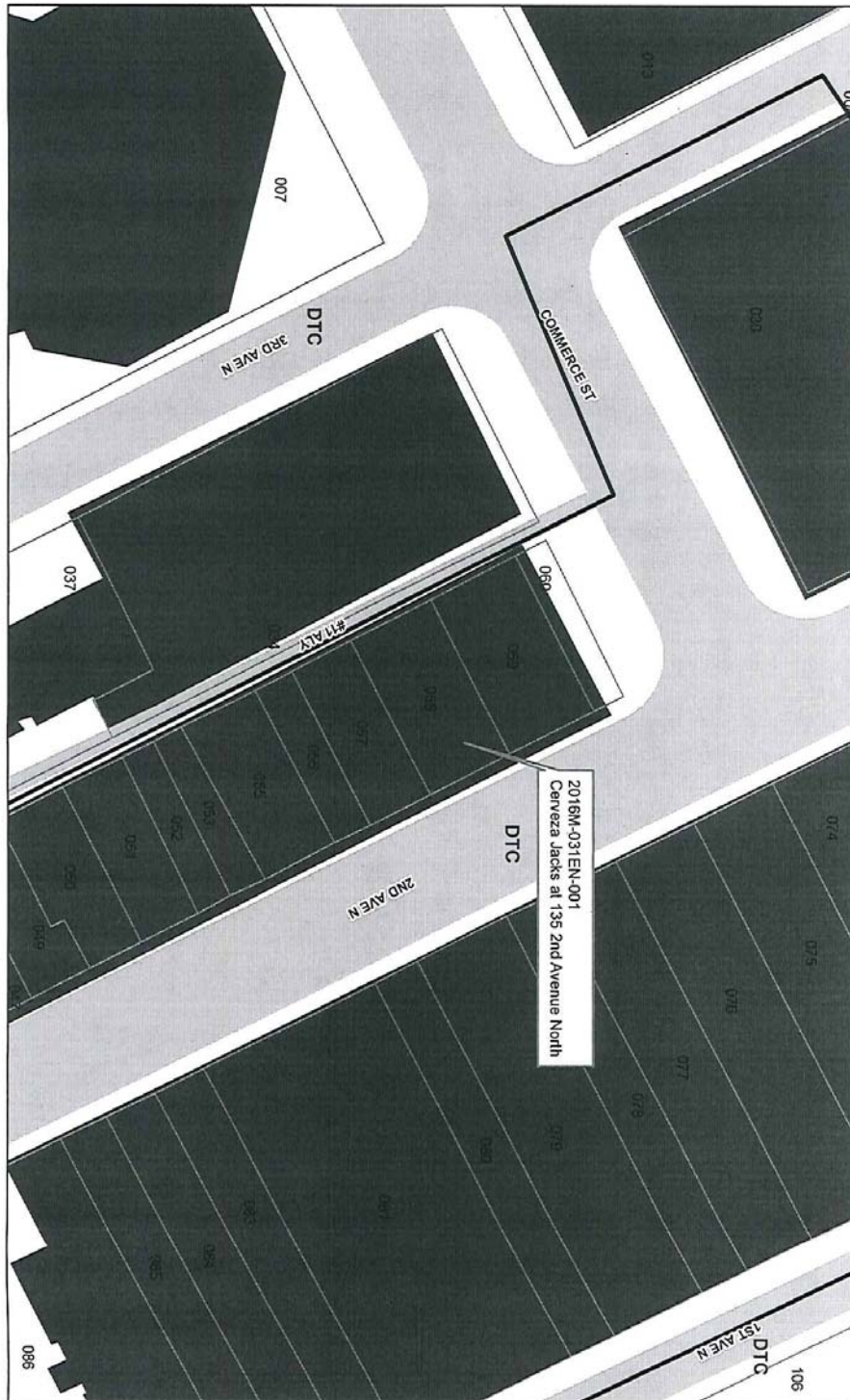

CERVEZA JACKS		SPECIFICATIONS & FINISHES:		APPROVALS		JOSLIN AND SON SIGNS 638 MacFadden Rd, Nashville, TN 37210 615.792.3421 • 615.792.4927
LOCATION:	135 2ND AVE N NASHVILLE, TN	1. FABRICATE/INSTALL ONE(1) OF PROJECTING SIGN AS ILLUSTRATED AND SPECIFIED.		DATE:	08-18-14	
JOB CONTACT NAME:	PROJECT MGR: M. SHEA	■ PMS 180 □ WHITE ■ BLACK		WORK ORDER NO.:	378562	
DRAWING NO.:	164078-MS10-01			PAGE:	1 OF 2	

1116013

NOTES:

- The fabricator shall coordinate with the architect and the client to determine the exact location of the sign on the building facade. The sign shall be installed in accordance with the International Building Code, the American National Standards Institute (ANSI) standards for signs, and the applicable local, state, and federal regulations. The sign shall be installed in accordance with the International Building Code, the American National Standards Institute (ANSI) standards for signs, and the applicable local, state, and federal regulations.
- STRUCTURAL STEEL: THE SIGN SHALL BE SUPPORTED BY 4" SQ TUBE STEEL SUPPORTS WITH 1/4" X 1/4" STEEL PLATES TOP & BOTTOM. SEE ENG SPECS ON PG-2.
- PAINTED IMAGE: THE SIGN SHALL BE SUPPORTED BY 4" SQ TUBE STEEL SUPPORTS WITH 1/4" X 1/4" STEEL PLATES TOP & BOTTOM. SEE ENG SPECS ON PG-2.
- PAINTED BORDER: THE SIGN SHALL BE SUPPORTED BY 4" SQ TUBE STEEL SUPPORTS WITH 1/4" X 1/4" STEEL PLATES TOP & BOTTOM. SEE ENG SPECS ON PG-2.
- OPEN FACE CHANNEL LETTERS: THE SIGN SHALL BE SUPPORTED BY 4" SQ TUBE STEEL SUPPORTS WITH 1/4" X 1/4" STEEL PLATES TOP & BOTTOM. SEE ENG SPECS ON PG-2.
- ACCESS DOORS: THE SIGN SHALL BE SUPPORTED BY 4" SQ TUBE STEEL SUPPORTS WITH 1/4" X 1/4" STEEL PLATES TOP & BOTTOM. SEE ENG SPECS ON PG-2.
- PAINTED LETTERS: THE SIGN SHALL BE SUPPORTED BY 4" SQ TUBE STEEL SUPPORTS WITH 1/4" X 1/4" STEEL PLATES TOP & BOTTOM. SEE ENG SPECS ON PG-2.

JOSLIN AND SON SIGNS
638 MacFadden Road
Nashville, TN 37210
Blair Sims
Contractor - 2800 East Avenue, Nashville, TN

DATE: 08-17-14
SCALE: 3/8" = 1'-0"
DRAWN BY: GREGORY, T.C.
CHECKED BY: T.C. GREGORY
PROJECT NO: 164078