

Proposal No. 2015M-029EN-001

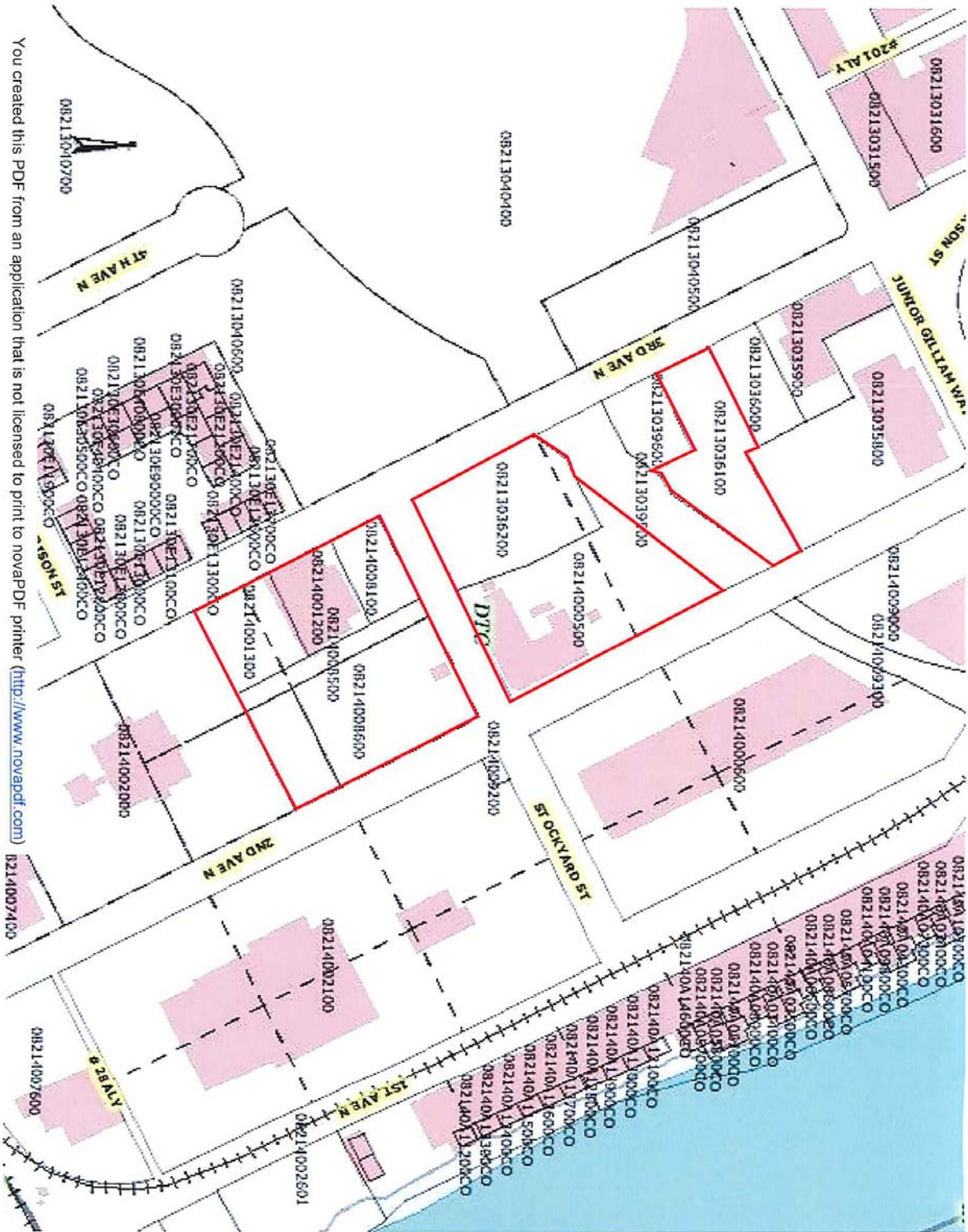

You created this PDF from an application that is not licensed to print to novaPDF printer (<http://www.novapdf.com>) B2140074100

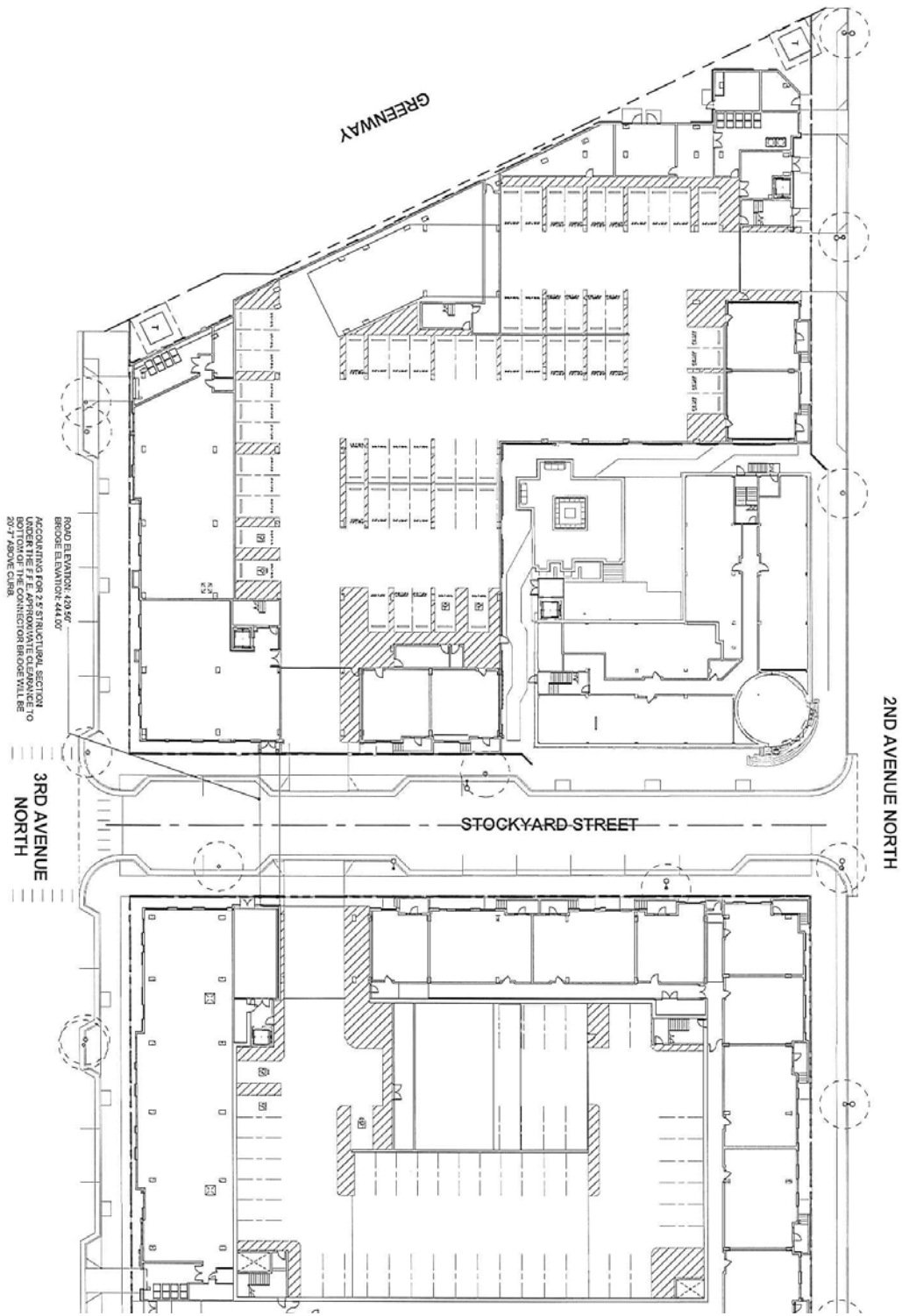

ROAD ELEVATION: 428.50'  
 BRIDGE ELEVATION: 444.00'  
 ACCORDING TO THE STRUCTURAL SECTION  
 UNDER THE F.F. APPROXIMATE CLEARANCE TO  
 BOTTOM OF THE CONNECTOR BRIDGE WILL BE  
 20'-7" ABOVE CURB.

3RD AVENUE  
 NORTH

STOCKYARD STREET

2ND AVENUE NORTH

GREENWAY

