

# Proposal No. 2017M-022EN-001

Client#: 1068881 ALLIARES7

**ACORD™ CERTIFICATE OF LIABILITY INSURANCE** DATE (MM/DD/YYYY)  
5/23/2017

THIS CERTIFICATE IS ISSUED AS A MATTER OF INFORMATION ONLY AND CONFERS NO RIGHTS UPON THE CERTIFICATE HOLDER. THIS CERTIFICATE DOES NOT AFFIRMATIVELY OR NEGATIVELY AMEND, EXTEND OR ALTER THE COVERAGE AFFORDED BY THE POLICIES BELOW. THIS CERTIFICATE OF INSURANCE DOES NOT CONSTITUTE A CONTRACT BETWEEN THE ISSUING INSURER(S), AUTHORIZED REPRESENTATIVE OR PRODUCER, AND THE CERTIFICATE HOLDER.

**IMPORTANT:** If the certificate holder is an ADDITIONAL INSURED, the policy(ies) must be endorsed. If SUBROGATION IS WAIVED, subject to the terms and conditions of the policy, certain policies may require an endorsement. A statement on this certificate does not confer rights to the certificate holder in lieu of such endorsement(s).

<b>PRODUCER</b> USI Insurance Services LLC 2375 E. Camelback Rd, Suite 250 Phoenix, AZ 85016 602 279-5800	<b>CONTACT NAME:</b> Clorinda Thompson <b>PHONE (A/C, No, Ext):</b> 602-279-5800 <b>FAX (A/C, No):</b> 602-279-5899 <b>E-MAIL ADDRESS:</b> clorinda.thompson@usi.com														
<b>INSURED</b> Alliance Multifamily Builders, LLC 2525 E. Camelback Road, Suite 500 Phoenix, AZ 85016	<table border="1" style="width: 100%; border-collapse: collapse;"> <thead> <tr> <th style="text-align: left;">INSURER(S) AFFORDING COVERAGE</th> <th style="text-align: left;">NAIC #</th> </tr> </thead> <tbody> <tr> <td>INSURER A : Gemini Insurance Company</td> <td>10833</td> </tr> <tr> <td>INSURER B : Admiral Insurance Company</td> <td>24856</td> </tr> <tr> <td>INSURER C : Endurance American Insurance Co</td> <td>10641</td> </tr> <tr> <td>INSURER D : Aspen American Insurance Compan</td> <td>43460</td> </tr> <tr> <td>INSURER E : Travelers Property Cas. Co.</td> <td>25674</td> </tr> <tr> <td>INSURER F :</td> <td></td> </tr> </tbody> </table>	INSURER(S) AFFORDING COVERAGE	NAIC #	INSURER A : Gemini Insurance Company	10833	INSURER B : Admiral Insurance Company	24856	INSURER C : Endurance American Insurance Co	10641	INSURER D : Aspen American Insurance Compan	43460	INSURER E : Travelers Property Cas. Co.	25674	INSURER F :	
INSURER(S) AFFORDING COVERAGE	NAIC #														
INSURER A : Gemini Insurance Company	10833														
INSURER B : Admiral Insurance Company	24856														
INSURER C : Endurance American Insurance Co	10641														
INSURER D : Aspen American Insurance Compan	43460														
INSURER E : Travelers Property Cas. Co.	25674														
INSURER F :															

**COVERAGES** **CERTIFICATE NUMBER:** **REVISION NUMBER:**

THIS IS TO CERTIFY THAT THE POLICIES OF INSURANCE LISTED BELOW HAVE BEEN ISSUED TO THE INSURED NAMED ABOVE FOR THE POLICY PERIOD INDICATED. NOTWITHSTANDING ANY REQUIREMENT, TERM OR CONDITION OF ANY CONTRACT OR OTHER DOCUMENT WITH RESPECT TO WHICH THIS CERTIFICATE MAY BE ISSUED OR MAY PERTAIN, THE INSURANCE AFFORDED BY THE POLICIES DESCRIBED HEREIN IS SUBJECT TO ALL THE TERMS, EXCLUSIONS AND CONDITIONS OF SUCH POLICIES. LIMITS SHOWN MAY HAVE BEEN REDUCED BY PAID CLAIMS.

INSR LTR	TYPE OF INSURANCE	ADDL SUBR INSR	WVD	POLICY NUMBER	POLICY EFF (MM/DD/YYYY)	POLICY EXP (MM/DD/YYYY)	LIMITS
A	<input checked="" type="checkbox"/> COMMERCIAL GENERAL LIABILITY <input type="checkbox"/> CLAIMS-MADE <input checked="" type="checkbox"/> OCCUR <input checked="" type="checkbox"/> BI/PD Ded: \$5,000 GENTL AGGREGATE LIMIT APPLIES PER: <input type="checkbox"/> POLICY <input checked="" type="checkbox"/> PROJECT <input type="checkbox"/> LOC OTHER:			VMGP002760	01/31/2017	01/31/2018	EACH OCCURRENCE \$1,000,000 DAMAGE TO RENTED PREMISES (Ea occurrence) \$100,000 MED EXP (Any one person) \$5,000 PERSONAL & ADV INJURY \$1,000,000 GENERAL AGGREGATE \$2,000,000 PRODUCTS - COMP/OP AGG \$2,000,000 \$
E	AUTOMOBILE LIABILITY <input type="checkbox"/> ANY AUTO <input type="checkbox"/> ALL OWNED AUTOS <input checked="" type="checkbox"/> HIRED AUTOS <input type="checkbox"/> SCHEDULED AUTOS <input checked="" type="checkbox"/> NON-OWNED AUTOS			BA3958B417	12/01/2016	12/01/2017	COMBINED SINGLE LIMIT (Ea accident) \$1,000,000 BODILY INJURY (Per person) \$ BODILY INJURY (Per accident) \$ PROPERTY DAMAGE (Per accident) \$ \$
B	<input type="checkbox"/> UMBRELLA LIAB <input checked="" type="checkbox"/> EXCESS LIAB <input type="checkbox"/> OCCUR <input checked="" type="checkbox"/> CLAIMS-MADE DED: RETENTION \$None			BEX0960257000	01/31/2017	01/31/2018	EACH OCCURRENCE \$10,000,000 AGGREGATE \$10,000,000 \$ PER STATUTE OTH-ER E.L. EACH ACCIDENT \$ E.L. DISEASE - EA EMPLOYEE \$ E.L. DISEASE - POLICY LIMIT \$
C	WORKERS COMPENSATION AND EMPLOYERS' LIABILITY ANY PROPRIETOR/PARTNER/EXECUTIVE OFFICER/MEMBER EXCLUDED? (Mandatory in NH) If yes, describe under DESCRIPTION OF OPERATIONS below			EXC30000246700	01/31/2017	01/31/2018	\$15,000,000/\$15,000,000
D	Excess of \$10M			CX0056D17	01/31/2017	01/31/2018	\$25,000,000/\$25,000,000

**DESCRIPTION OF OPERATIONS / LOCATIONS / VEHICLES (ACORD 101, Additional Remarks Schedule, may be attached if more space is required)**  
 Re: Broadstone South Gulch, 777 8th Avenue South, Nashville, TN. The General Liability policy includes an automatic Additional Insured endorsement that provides Additional Insured status to the Certificate holder, only when there is a written contract or written agreement between the named insured and the certificate holder and with regard to work performed on behalf of the named insured. The General Liability policy includes an endorsement providing that 30 days notice of cancellation will be given to the Certificate (See Attached Descriptions)

<b>CERTIFICATE HOLDER</b> The Metropolitan Government of Nashville and Davidson County Metro Legal & Claims C/O Insurance Safety Division 222 3rd Ave North Ste #501 Nashville, TN 37201	<b>CANCELLATION</b> SHOULD ANY OF THE ABOVE DESCRIBED POLICIES BE CANCELLED BEFORE THE EXPIRATION DATE THEREOF, NOTICE WILL BE DELIVERED IN ACCORDANCE WITH THE POLICY PROVISIONS. AUTHORIZED REPRESENTATIVE 
---	--

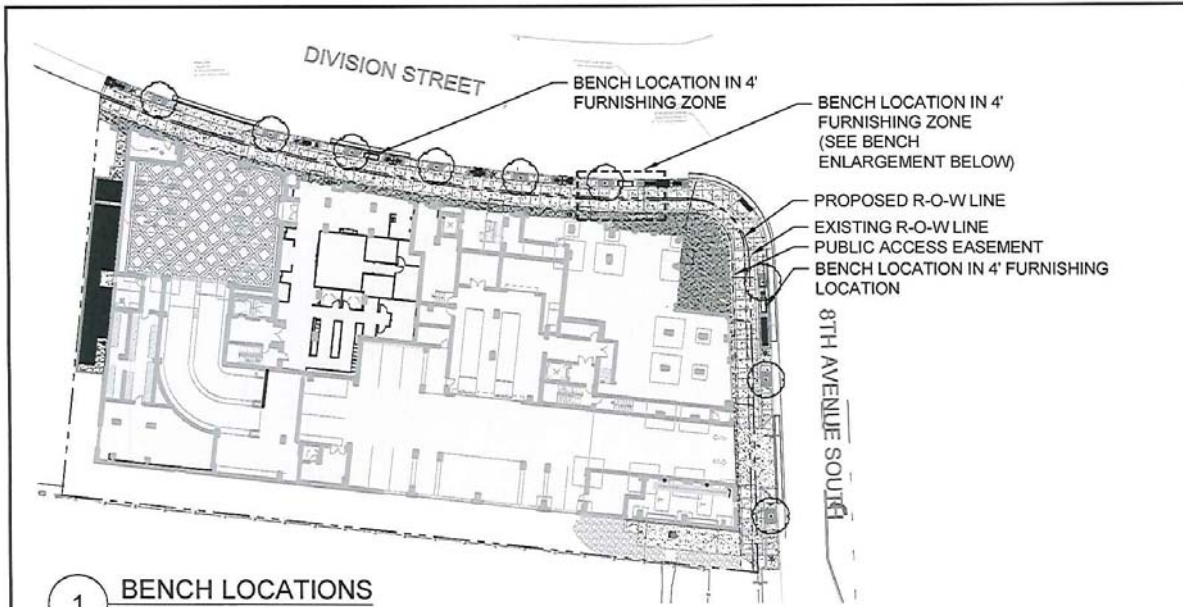

**1 BENCH LOCATIONS**  
SCALE: 1" = 60'

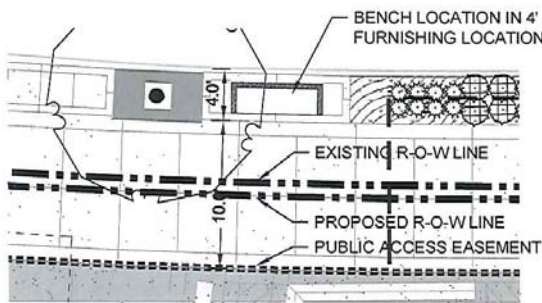

**2 BENCH ENLARGEMENT**  
SCALE: 1" = 10'



**BENCH: CONTEMPORARY**

PRODUCT: As listed below or approved equal

- LANDSCAPE FORMS: Chase Park
- 3 Seat Unit
- (2) Intermediate Arms (not shown in illustration)
- Embedded

MATERIAL: Cast Aluminum Seats and Back, Cast Steel Frame  
FINISH: Silver Powdercoat

**3 BENCH INFORMATION**  
NOT TO SCALE

SCALE:	AS SHOWN
DATE:	05/23/2017
DESIGNED BY:	N/A
DRAWN BY:	PHN
KH PROJECT NO.:	118117003
DEVELOPER: ALLIANCE RESIDENTIAL	

NOTE: BENCH DESIGN PER METRO NASHVILLE "CONTEMPORARY" SUB-DISTRICT DESIGN GUIDELINES

SHEET: **L1**



STREETSCAPE BENCHES IN R-O-W		
BROADSTONE SOUTH GULCH		
DAVIDSON COUNTY	NASHVILLE	TENNESSEE

**R-O-W  
ENCROACHMENT  
EXHIBIT**

**Kimley»Horn**

214 Oceanside Drive, Nashville, TN 37204  
Main: 615.564.2701 | www.kimley-horn.com  
© 2016 Kimley-Horn and Associates, Inc.

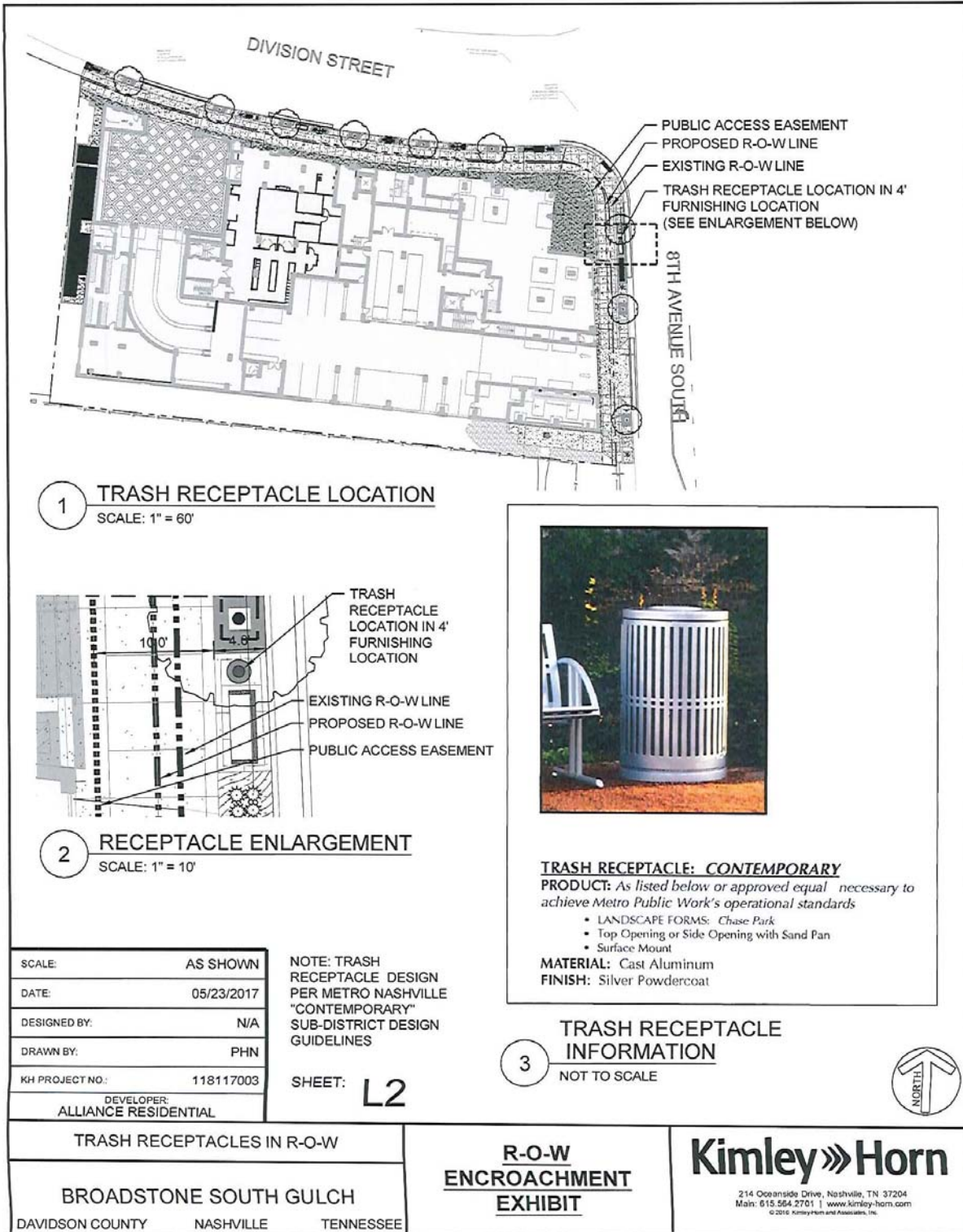

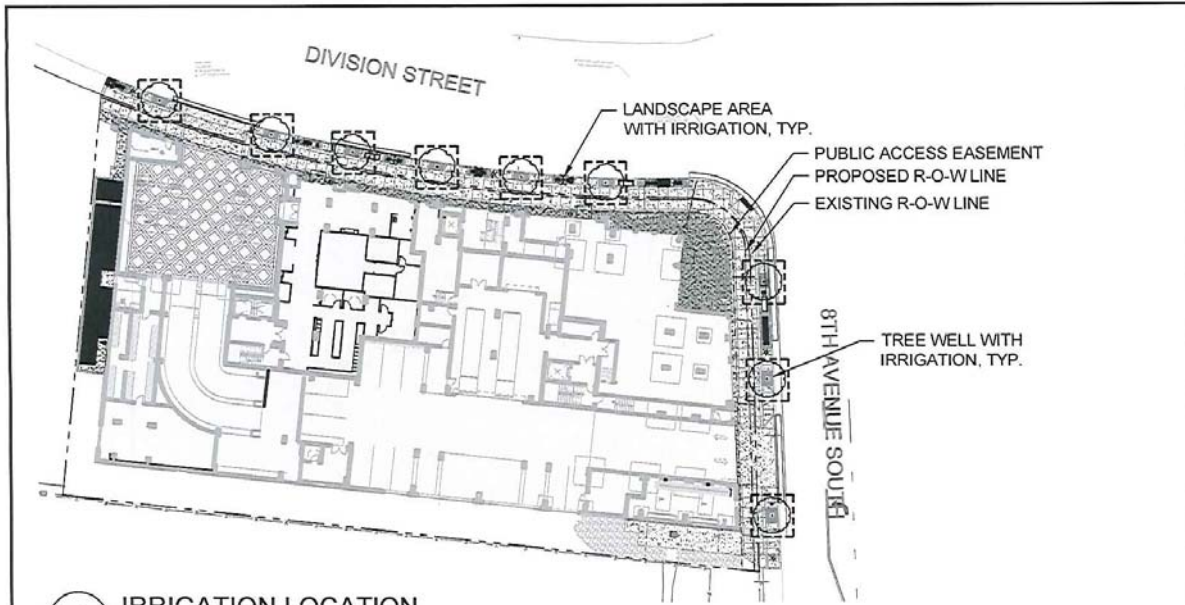

**1 IRRIGATION LOCATION**  
SCALE: 1" = 60'

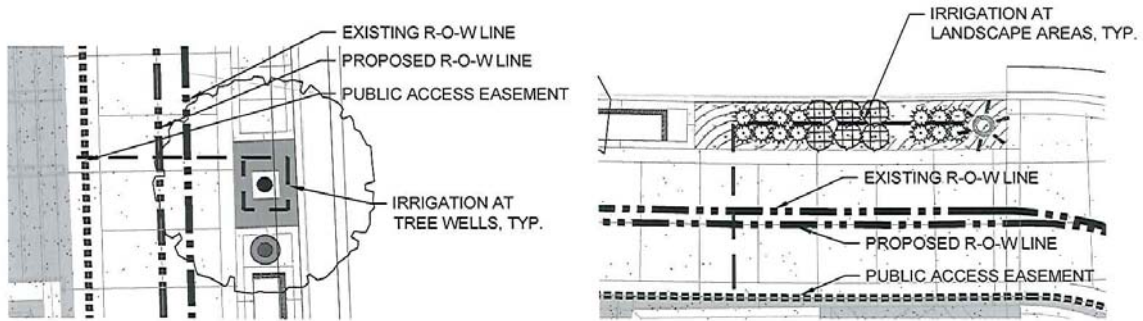

**2 IRRIGATION ENLARGEMENT**  
SCALE: 1" = 10'

SCALE:	AS SHOWN
DATE:	05/23/2017
DESIGNED BY:	N/A
DRAWN BY:	PHN
KH PROJECT NO.:	118117003
DEVELOPER: ALLIANCE RESIDENTIAL	

SHEET: **L3**



IRRIGATION IN R-O-W	<b>R-O-W ENCROACHMENT EXHIBIT</b>	<b>Kimley»Horn</b>
<b>BROADSTONE SOUTH GULCH</b>		214 Oceanside Drive, Nashville, TN 37204 Main: 615.564.2701   www.kimley-horn.com © 2010 Kimley-Horn and Associates, Inc.
DAVIDSON COUNTY    NASHVILLE    TENNESSEE		

Drawing name: K:\NSH\_LDEV\118117003 - 777 8th Avenue\4-CADD\3-Exhibits\ROW\Encroachment\Exhibits.dwg    Layout1 (B)    May 23, 2017 4:35pm    by: Philip Neal

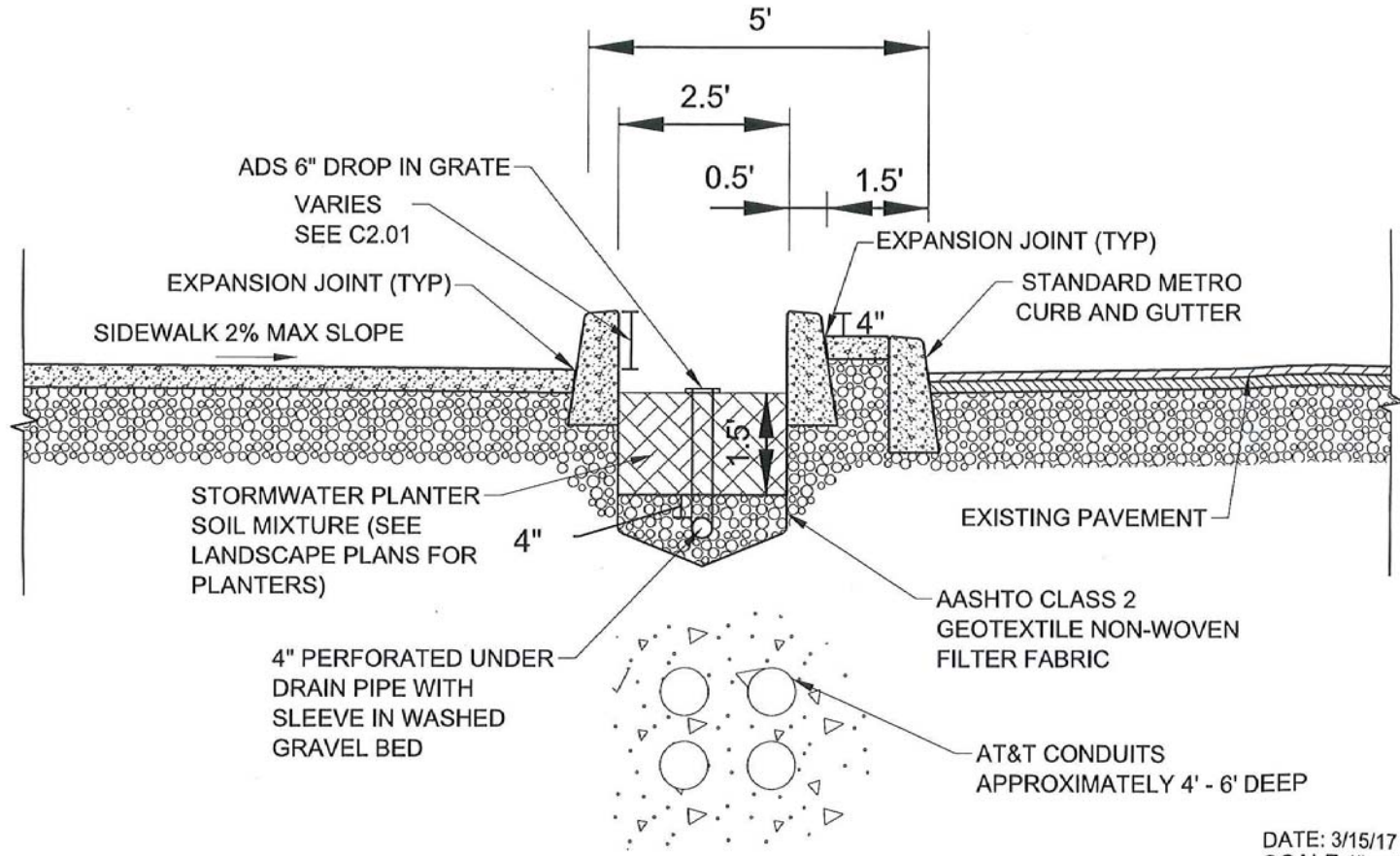

STORMWATER PLANTER DETAIL

DATE: 3/15/17  
SCALE 1" = 2'  
**BWSC** BARKER WOODSON BRUNNER & BANNON, INC.