

CAUTION
 THE POSITION OF THE WATER AND SANITARY SEWER MAINS SHOWN ARE APPROXIMATE AND ARE INTENDED TO SHOW THE GENERAL LOCATION ONLY. THE SIZES NOTED ARE TO THE BEST OF MWS KNOWLEDGE. IN ALL CASES WHERE PRECISE LOCATION AND MAIN SIZES ARE REQUIRED, FIELD VERIFICATION WILL BE NECESSARY.

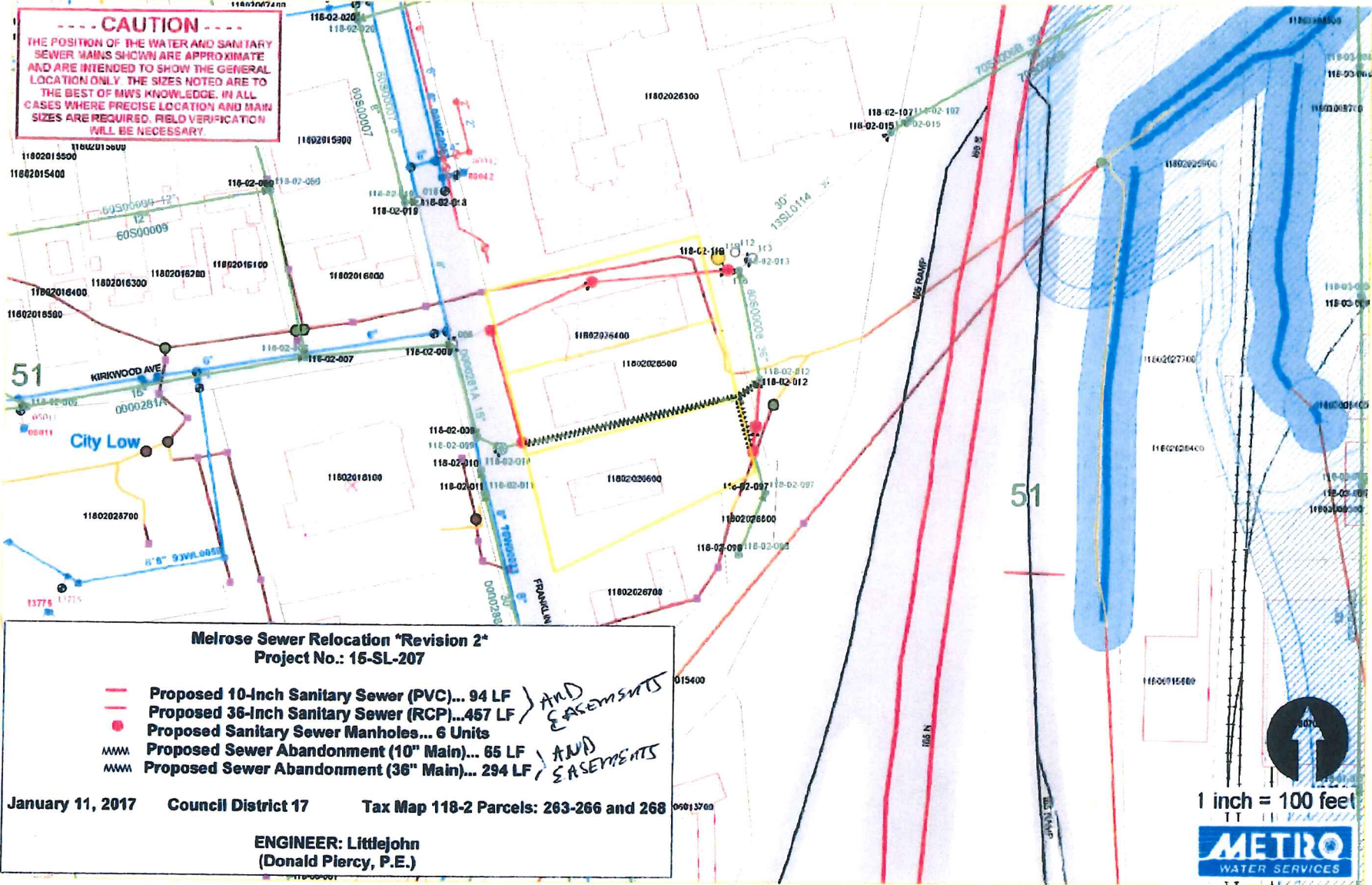

Melrose Sewer Relocation *Revision 2*
 Project No.: 15-SL-207

	Proposed 10-Inch Sanitary Sewer (PVC)... 94 LF	} AND EASEMENTS
	Proposed 36-Inch Sanitary Sewer (RCP)... 457 LF	
	Proposed Sanitary Sewer Manholes... 6 Units	} AND EASEMENTS
	Proposed Sewer Abandonment (10" Main)... 65 LF	
	Proposed Sewer Abandonment (36" Main)... 294 LF	

January 11, 2017 Council District 17 Tax Map 118-2 Parcels: 263-266 and 268

ENGINEER: Littlejohn
 (Donald Piercy, P.E.)

1 inch = 100 feet

METRO
 WATER SERVICES

List of Parcels

Melrose Sewer Abandonment Project

<u>Address</u>	<u>Tax Map & Parcel</u>
2600 Franklin Pike	11802026300
2608 Franklin Pike	11802026400
2610 Franklin Pike	11802026500
2612 Franklin Pike	11802026600