

# INDEX

SHEET NO.	SHEET NAME
1	TITLE SHEET & INDEX
2	STANDARD DRAWINGS
2A	ESTIMATED QUANTITIES
2B-2C	TYPICAL SECTIONS
2D-2D4	STANDARD DETAILS
25	GENERAL NOTES
2T-2V	RETAINING WALL DETAILS AND DESIGN
2W-2X	DRIVEWAY PROFILES
3-3E	R.O.W. SHEETS
4-4C	PRESENT, PROPOSED LAYOUT, STORMWATER, PROPOSED PROFILE
5-5C	PRESENT, PROPOSED LAYOUT, STORMWATER, PROPOSED PROFILE
6-6C	PRESENT, PROPOSED LAYOUT, STORMWATER, PROPOSED PROFILE
7-7C	PRESENT, PROPOSED LAYOUT, STORMWATER, PROPOSED PROFILE
8-8C	PRESENT, PROPOSED LAYOUT, STORMWATER, PROPOSED PROFILE
9-9C	PRESENT, PROPOSED LAYOUT, STORMWATER, PROPOSED PROFILE
10-10E	EROSION CONTROL SHEETS (PHASE 1)
11-11E	EROSION CONTROL SHEETS (PHASE 2)
12	TRAFFIC CONTROL SHEET
13-13E	UTILITY SHEETS
14-23	PROPOSED CROSS-SECTIONS

\* NOTE: LETTERS "I" AND "O" NOT USED

# METROPOLITAN GOVERNMENT OF NASHVILLE AND DAVIDSON COUNTY DEPARTMENT OF PUBLIC WORKS

## DAVIDSON COUNTY COUNCIL DISTRICT 8

### MAPLEWOOD TRACE SIDEWALK IMPROVEMENTS FROM DICKERSON PIKE TO WALTON LANE (PROJECT LENGTH APPROXIMATELY 2260 FT)

FILE NO.	COVER 54T
DATE:	10-04-2017
DESIGNED BY:	JH
DRAWN BY:	JM
CHECKED BY:	JM
REVISION BLOCK	
DATE:	
DATE:	
DATE:	

PROJECT NO. 2017-R-09  
SWGR No. 2017029563  
100% DESIGN

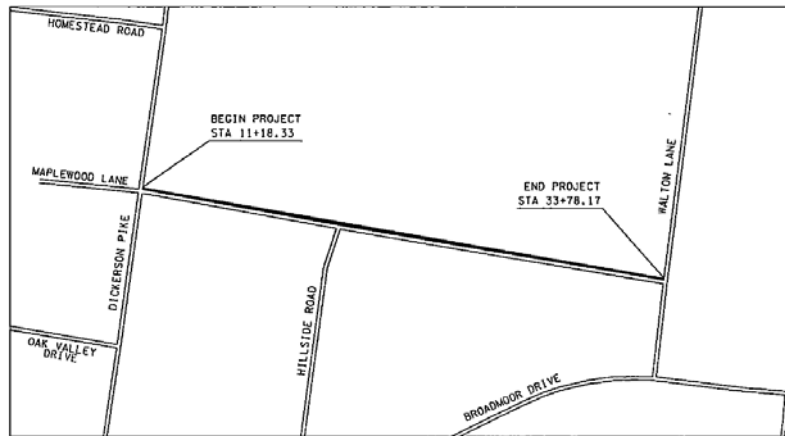

SCALE: 1"=200'



### SPECIAL NOTES

PROPOSALS MAY BE REJECTED IF ANY OF THE UNIT PRICES CONTAINED THEREIN ARE OBVIOUSLY UNBALANCED, EITHER EXCESSIVE OR BELOW THE REASONABLE COST ANALYSIS VALUE.

THIS PROJECT TO BE CONSTRUCTED UNDER THE STANDARD SPECIFICATIONS OF THE TENNESSEE DEPARTMENT OF TRANSPORTATION DATED JANUARY 1, 2015, AND ADDITIONAL SPECIFICATIONS AND SPECIAL PROVISIONS CONTAINED IN THE PLANS AND IN THE CONTRACT.

ALL DESIGN AND CONSTRUCTION ACTIVITIES SHALL BE COMPLETED IN FULL COMPLIANCE WITH THE AMERICANS WITH DISABILITIES ACT (ADA), 2010 STANDARDS FOR ACCESSIBLE DESIGN, AS HAS BEEN ADOPTED BY METRO.



Project Authorized by Council Resolution No.

APPROVED: \_\_\_\_\_  
DIRECTOR of ENGINEERING Date

File No. \_\_\_\_\_ Sheet 1 of 23

**MAPLEWOOD TRACE**

**R.O.W. ACQUISITION TABLE**

Project No. 2017-R-009

TRACT NO.	PROPERTY OWNER	COUNTY RECORDS					EASEMENTS			PROPERTY ADDRESS
		TAX MAP NO.	PARCEL NO.	DEED BOOK	PAGE	INSTRUMENT NUMBER	AREA TO BE ACQUIRED (SF)	DRAINAGE (SF)	TEMPORARY CONSTRUCTION (SF)	
1	3201 DICKERSON PROPERTIES, LLC	60-04	22			20150805 0077879	4429	1916	6665	3201 DICKERSON PIKE
2	CARMIKE CINEMAS, INC.	60-04	104	6687	713				60	0 MAPLEWOOD TRACE
3	ANDREW LAPARRA AND LINDSEY LAPARRA	60-04	23			20160812 0084036		91	202	201 MAPLEWOOD TRACE
4	THE RK COMPANY	50-00	76	10381	379			182	791	0 DICKERSON PIKE
5	PEM SETTLES, ETUX	60-04	26	2903	625				440	205 MAPLEWOOD TRACE
6	ISAIAH KALLMAN AND CHELSEA KALLMAN	60-04	27			20150319 0023701		80	212	207 MAPLEWOOD TRACE
7	TERRY R. CHILDRESS	60-04	28			2000040 70035186		88	212	209 MAPLEWOOD TRACE
8	PETER A. GROENWALD AND ISAACA B. GROENWALD	60-04	29			20120524 0045062		368	500	215 MAPLEWOOD TRACE
9	ROY LEE REED	60-04	30	8838	485				715	217 MAPLEWOOD TRACE
10	ERNEST T. SEABROOK	60-04	31	8997	45				148	219 MAPLEWOOD TRACE
11	PATRICIA DIANE EARNHARDT	60-04	32			20150701 0063677			400	221 MAPLEWOOD TRACE
12	CHERYL IRENE HATCHER	60-04	33	6648	368				400	223 MAPLEWOOD TRACE
13	THOMAS J. WATSON	61-10	2			20121018 0095496			150	225 MAPLEWOOD TRACE
14	JERRY SHRUM AND JOYCE SHRUM	61-10	3			20151215 0125829	33	495	1146	229 MAPLEWOOD TRACE
15	KENNETH R. HOWELL AND KIMBERLY HOWELL	61-10	4			20021031 0133690		48	2103	231 MAPLEWOOD TRACE
16	GEORGE BLANTON WOOTEN, JR. AND BRENDA SUE WOOTEN	61-10	6			20150731 0075696		32	11	235 MAPLEWOOD TRACE
17	LEON DAVIS, JR. AND VALERIE DAVIS	61-10	7			20000607 0056886			320	237 MAPLEWOOD TRACE
18	ULISES A. BATRES	61-10	8			20101004 0079035	50		313	239 MAPLEWOOD TRACE
19	KUDZU REAL ESTATE, INC.	60-04	44			20141113 0104708			618	122 MAPLEWOOD TRACE
20	AMY DEE RICHARDSON	61-10	53			20160303 0020489			2753	306 MAPLEWOOD TRACE