

Staybridge Suites
Project Nos.: 16-SL-236 and 16-WL-202

- Proposed Sanitary Sewer Manholes... 1 Unit
- Proposed Fire Hydrant Assemblies... 2 Units
- MMW Proposed 10" Combination Sewer Abandonment... 68 LF
- MMW Proposed 15" Combination Sewer Abandonment... 243 LF

March 16, 2017 Council District 21 Parcel ID: 09211028900

ENGINEER: Ragan Smith
(Joshua Hunter, P.E.)

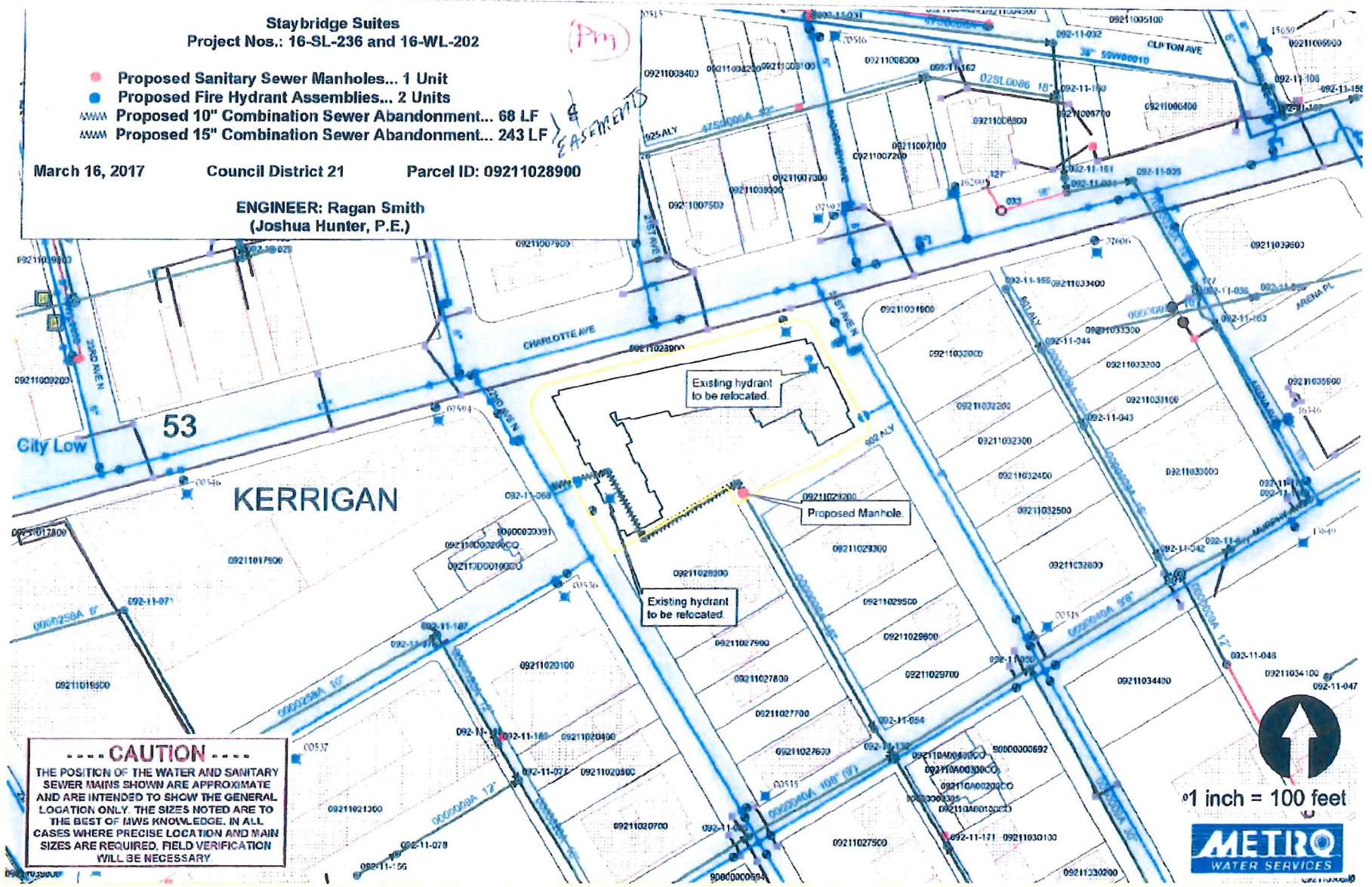

CAUTION

THE POSITION OF THE WATER AND SANITARY SEWER MAINS SHOWN ARE APPROXIMATE AND ARE INTENDED TO SHOW THE GENERAL LOCATION ONLY. THE SIZES NOTED ARE TO THE BEST OF MWS KNOWLEDGE. IN ALL CASES WHERE PRECISE LOCATION AND MAIN SIZES ARE REQUIRED, FIELD VERIFICATION WILL BE NECESSARY.



350 22nd Ave N