

Vicinity Sketch

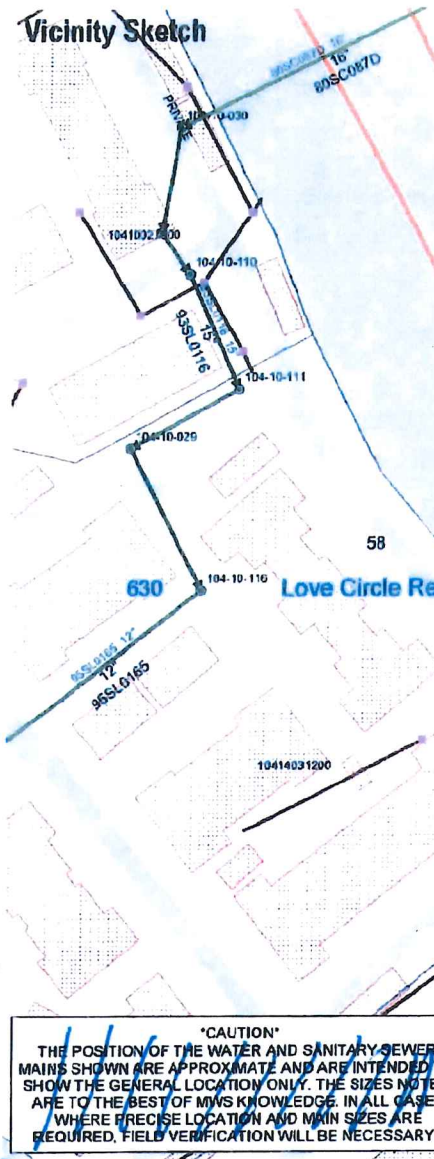

519 - 521 Chesterfield Avenue
 MWS Project Nos.: 16-SL-69 and 16-WL-96

AAAAA Proposed Sanitary Sewer Abandonment... 165 LF **EASEMENT**
--- Proposed 8-Inch Sanitary Sewer Main (PVC)... 48 LF **EASEMENTS**
● Proposed 8-Inch Sanitary Sewer Main (DIP)... 134 LF **EASEMENTS**
--- Proposed Sanitary Sewer Manholes... 3 Units **EASEMENT**
--- Proposed 6-Inch Water Main (DIP)... 262 LF **EASEMENT**

September 9, 2016 Council District 18 Map: 104-10 and 104-14 Parcels: 109 and 008

ENGINEER: DBS & Associates Engineering
 (Houston Smith, P.E.)

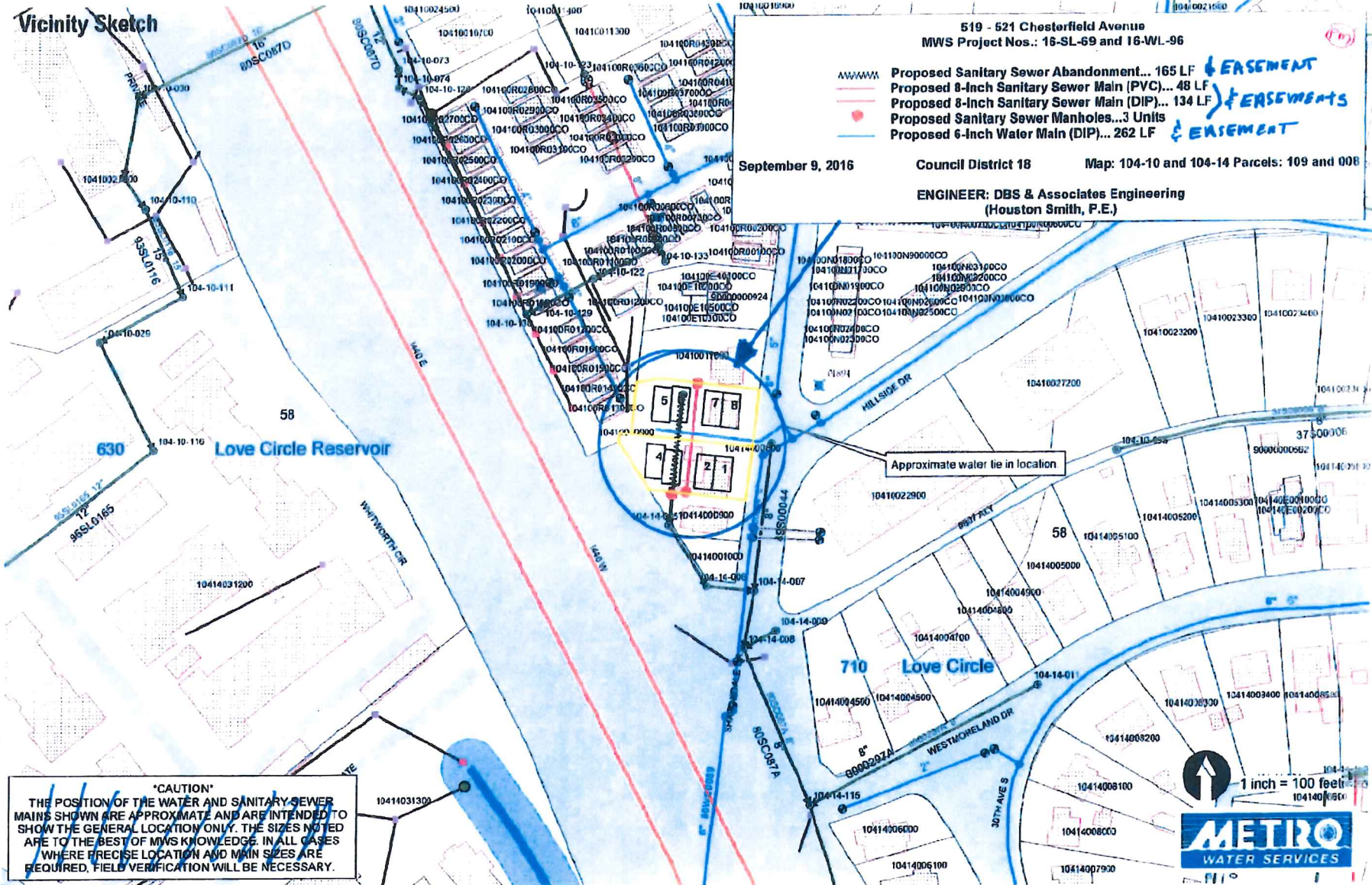

CAUTION
 THE POSITION OF THE WATER AND SANITARY SEWER MAINS SHOWN ARE APPROXIMATE AND ARE INTENDED TO SHOW THE GENERAL LOCATION ONLY. THE SIZES NOTED ARE TO THE BEST OF MWS KNOWLEDGE. IN ALL CASES WHERE PRECISE LOCATION AND MAIN SIZES ARE REQUIRED, FIELD VERIFICATION WILL BE NECESSARY.

1 inch = 100 feet

METRO
 WATER SERVICES