

CAUTION
 THE POSITION OF THE WATER AND SANITARY SEWER MAINS SHOWN ARE APPROXIMATE AND ARE INTENDED TO SHOW THE GENERAL LOCATION ONLY. THE SIZES NOTED ARE TO THE BEST OF MVE'S KNOWLEDGE. IN ALL CASES WHERE PRECISE LOCATION AND MAIN SIZES ARE REQUIRED, FIELD VERIFICATION WILL BE NECESSARY.

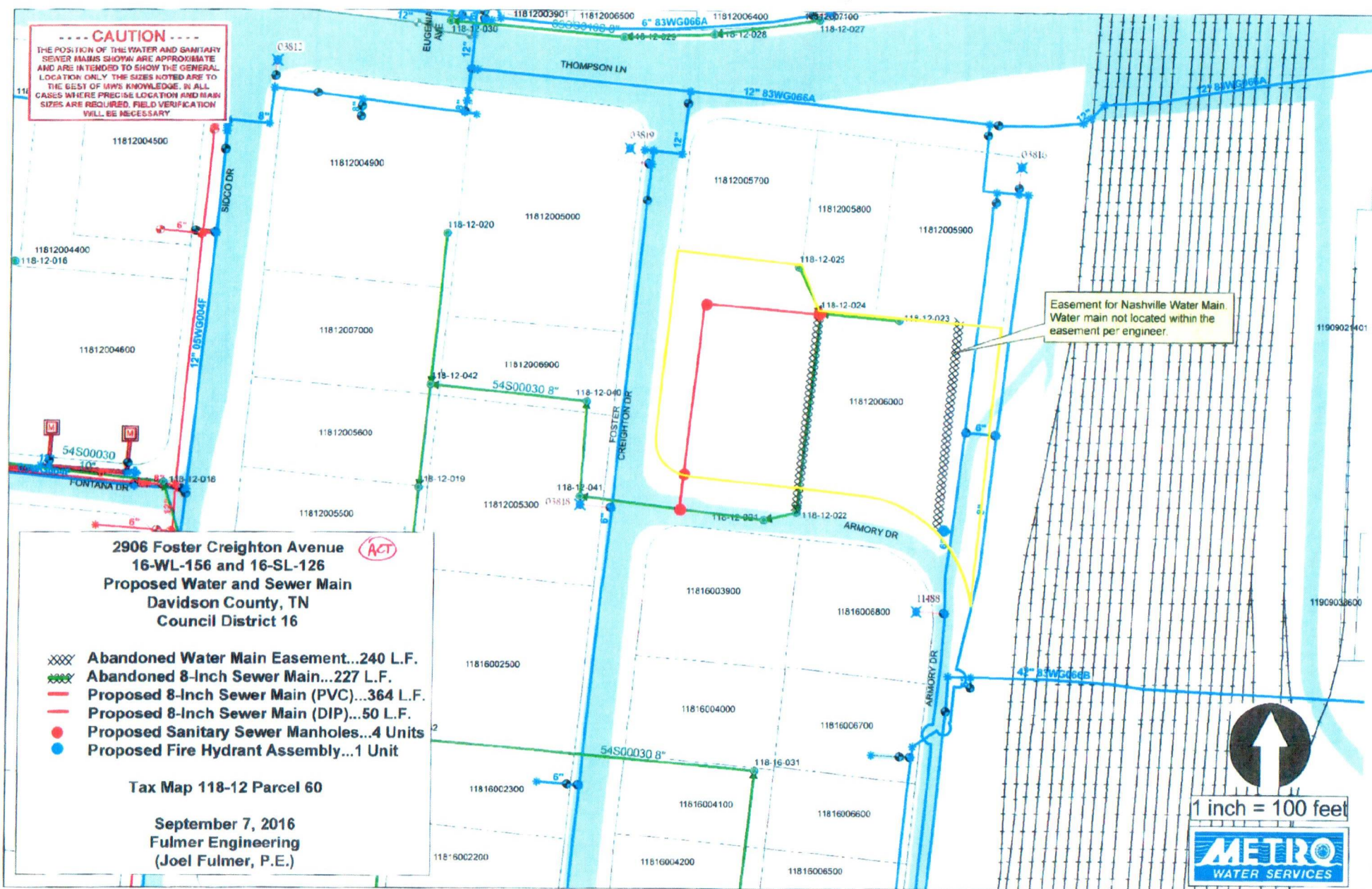

Easement for Nashville Water Main. Water main not located within the easement per engineer.

2906 Foster Creighton Avenue (ACT)
 16-WL-156 and 16-SL-126
 Proposed Water and Sewer Main
 Davidson County, TN
 Council District 16

- XXXX Abandoned Water Main Easement...240 L.F.
- XXXX Abandoned 8-Inch Sewer Main...227 L.F.
- Proposed 8-Inch Sewer Main (PVC)...364 L.F.
- Proposed 8-Inch Sewer Main (DIP)...50 L.F.
- Proposed Sanitary Sewer Manholes...4 Units
- Proposed Fire Hydrant Assembly...1 Unit

Tax Map 118-12 Parcel 60

September 7, 2016
 Fulmer Engineering
 (Joel Fulmer, P.E.)

1 inch = 100 feet

METRO
 WATER SERVICES