

List of Parcels**Inga Street Stormwater Improvement Project****MWS Project No. 14-SWC-210**

<u>Address</u>	<u>Tax Map & Parcel</u>
2701 Inga Street	07209028500
2701(a) Inga Street	07209028600
2611 Inga Street	07209028700
2609 Inga Street	07209028800
2607 Inga Street	07209028900
901 Cahal Avenue	07209035600
903 Cahal Avenue	07209035500
905 Cahal Avenue	07209035400
907 Cahal Avenue	07209035200
911 Cahal Avenue	07209035000
900 Carolyn Avenue	07209032500
902 Carolyn Avenue	07209032600
904 Carolyn Avenue	07209032700
906 Carolyn Avenue	07209032800
908 Carolyn Avenue	07209032900
910 Carolyn Avenue	07209033000

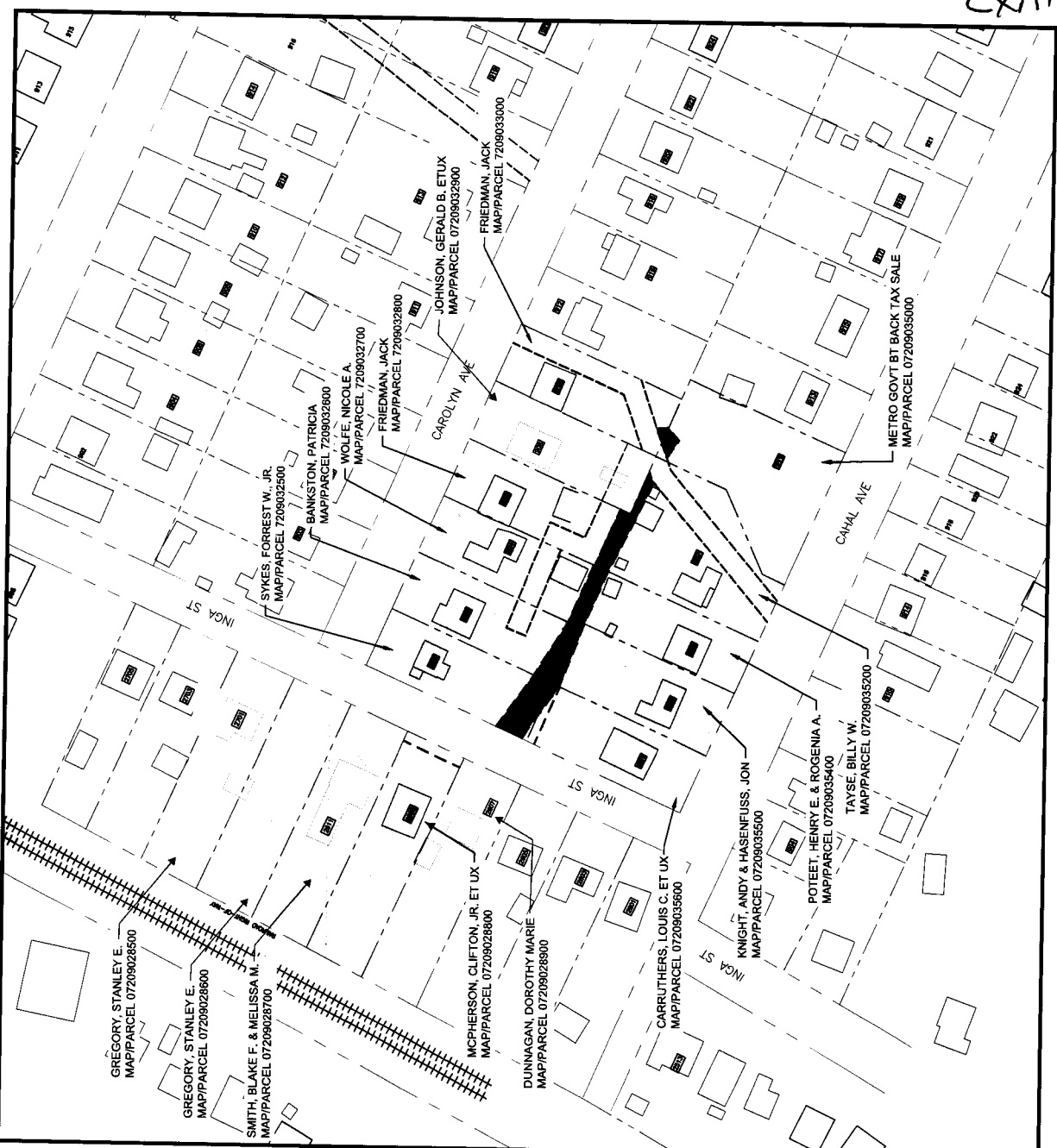

LEGEND

	PROPERTY LINE
	PROPOSED PERMANENT EASEMENT
	EXISTING EASEMENT
	PROPOSED TEMPORARY EASEMENT
	PROPERTY WITH PROPOSED EASEMENT

**INGA STREET
STORMWATER IMPROVEMENTS**
 Proj. No. 14-SWC-210

SCALE: 1" = 100'

**METRO WATER SERVICES, DIVISION OF
STORMWATER**

 Palmer ENGINEERING NASHVILLE WINCHESTER LOUISVILLE MIDDLETOWN TEAYS VALLEY ORLANDO 2416 21st AVENUE SOUTH NASHVILLE, TENNESSEE 37212 PHONE: (615) 297-8857 FAX: (615) 297-8913	DWN BY:	MDS
	CHKD BY:	ME
	DATE:	06/26/14
	PROJECT NO.:	14-SWC-210