

METROPOLITAN GOVERNMENT OF NASHVILLE AND DAVIDSON COUNTY DEPARTMENT OF PUBLIC WORKS

DAVIDSON COUNTY NORTH DUPONT AVENUE SIDEWALK IMPROVEMENTS FROM DELAWARE AVENUE TO 465 FT EAST OF KINGSTON DRIVE (PROJECT LENGTH APPROXIMATELY 1750 FT)

INDEX

SHEET NO.	SHEET NAME
1	TITLE SHEET & INDEX
2	STANDARD SPECIFICATIONS
3	GENERAL NOTES
4	PROPOSED LAYOUT / PROFILE
5	PROPOSED LAYOUT / PROFILE
6	PROPOSED LAYOUT / PROFILE
7	PROPOSED LAYOUT / PROFILE
8	PROPOSED LAYOUT / PROFILE
9	PROPOSED LAYOUT / PROFILE
10	PROPOSED LAYOUT / PROFILE
11	PROPOSED LAYOUT / PROFILE
12	PROPOSED LAYOUT / PROFILE
13	PROPOSED LAYOUT / PROFILE
14	PROPOSED LAYOUT / PROFILE
15	PROPOSED LAYOUT / PROFILE
16	PROPOSED LAYOUT / PROFILE
17	PROPOSED LAYOUT / PROFILE
18	PROPOSED LAYOUT / PROFILE
19	PROPOSED LAYOUT / PROFILE
20	PROPOSED LAYOUT / PROFILE

BEGIN - PROJECT STA 10+23.73

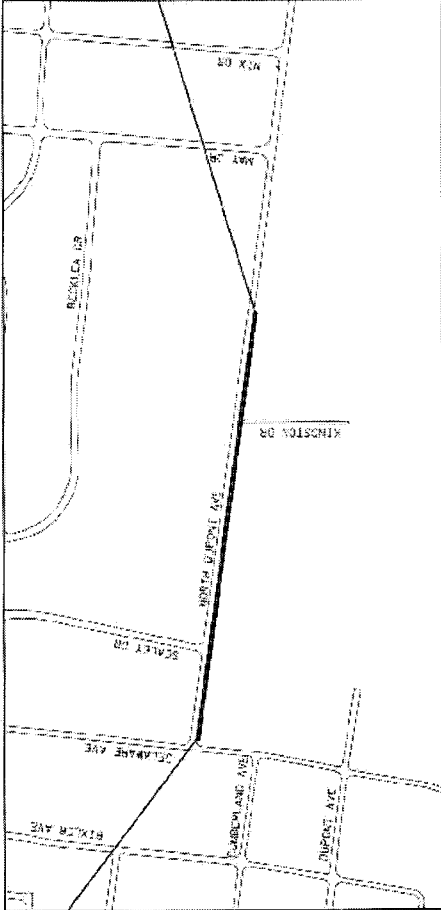

END PROJECT STA 27+73.32

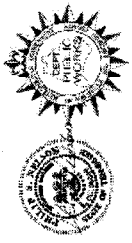

SCALE 1"=50'

Project Authorized by Council Resolution No.

APPROVED: *[Signature]*
DIRECTOR OF ENGINEERING

File No. _____ Date *6/14/15*
Sheet 1 of 17



ALL CONSTRUCTION ACTIVITIES SHALL BE CONDUCTED IN FULL COMPLIANCE WITH THE AMERICANS WITH DISABILITIES ACT (ADA) AND ARCHITECTURAL AND TRANSPORTATION BARRIERS COMPLIANCE ACT (ATBCA). ACCESSIBILITY PARTS ARE FOR BARRIERS AND FACILITIES. ACCESSIBILITY PARTS ARE NOT TO BE CONSIDERED AS ARCHITECTURAL BARRIERS ACT. THE PROPOSED PROJECT IS IN ACCORDANCE WITH THE ADA AND ATBCA AS HAS BEEN ADOPTED BY METRO.

SPECIAL NOTES

PROVIDE ANY OF THE NOTES CONTAINED THEREIN AND CONTACT UNLESS OTHERWISE NOTED BELOW THE REASONABLE CARE ANALYSIS VALUE.
THIS PROJECT TO BE CONSTRUCTED UNDER THE STANDARD SPECIFICATIONS OF THE TENNESSEE DEPARTMENT OF TRANSPORTATION DATED MARCH 1, 2004, WITH ANY APPLICABLE SPECIAL NOTES AND SPECIAL PROVISIONS CONTAINED IN THE PLAN AND IN THE SPECIFICATIONS.

NORTH DUPONT AVENUE BETWEEN DEWILARE AVENUE AND 445 EAST OF KINGSTON DRIVE PROJECT NO. 311R-011 R.O.W. ACQUISITION TABLE												
TRACT NO.	PROPERTY OWNER	COUNTY RECORDS				ASSETS TO BE ACQUIRED		EASEMENTS				
		TAX MAP NO.	SARCEL NO. BOOK	PAGE	INSTRUMENT NUMBER	AREA TO BE ACQUIRED (SQ. FT.)	DRAINAGE (SQ. FT.)	TEMPORARY CONSTRUCTION (SQ. FT.)	PERMANENT CONSTRUCTION (SQ. FT.)	OTHER	OTHER	
1	JAMES M. & ANNE C. J. NORVAL S	4309	138	-	-	-	-	-	-	-	-	X
2	KINGS COUNTRY DEVELOPMENT	4310	3401	-	-	-	-	-	-	-	-	X
4	WAGON GROUND CORP. TRUSTEES	4310	90	600	182	-	-	-	-	-	-	X