



McGAVOCK PIKE

06-12-07

EXHIBIT:

TOURISM

DEVELOPMENT ZONE

PG.1

AS PART OF

GAYLORD OPRYLAND RESORT
AND CONVENTION CENTER

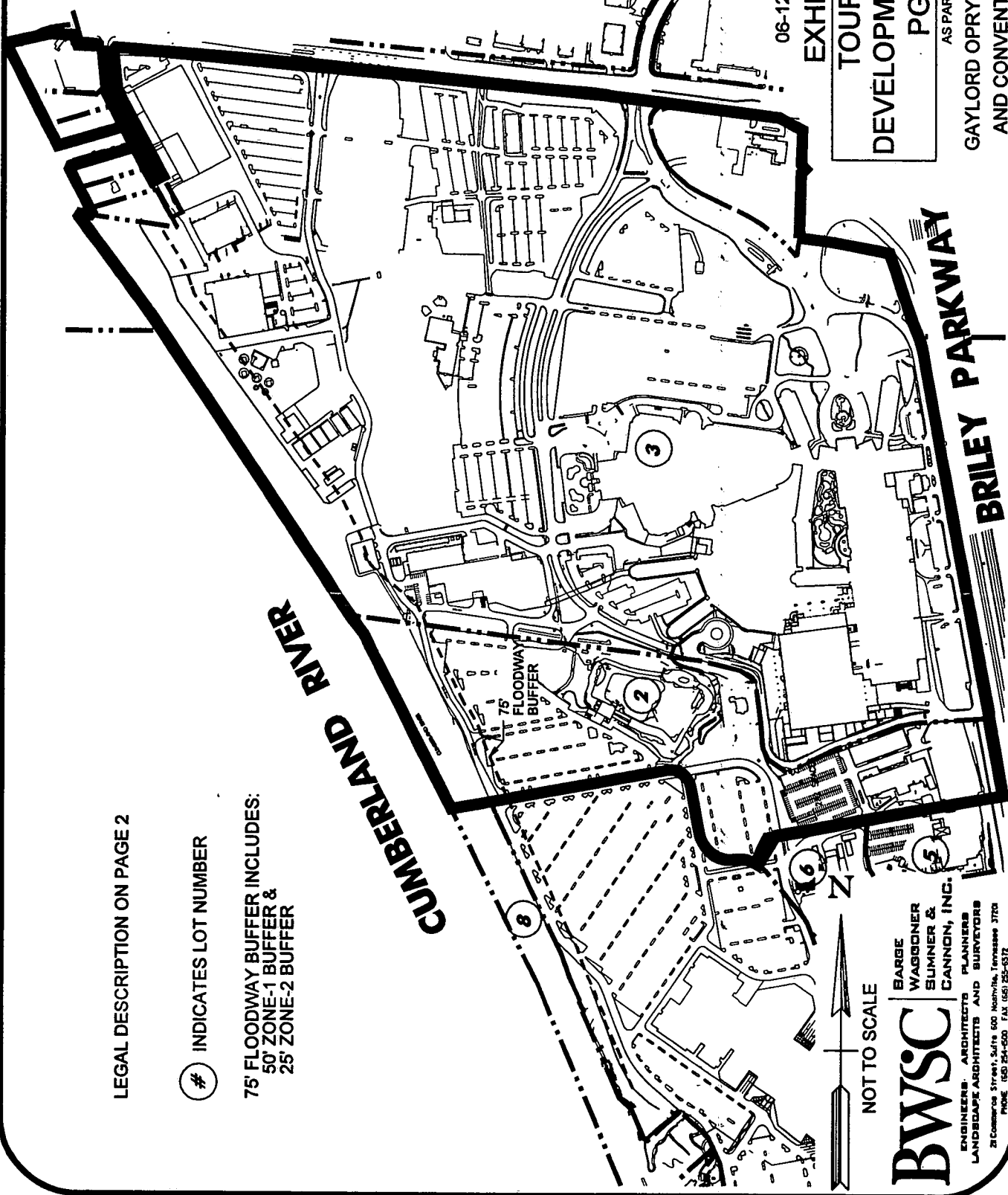

LEGAL DESCRIPTION ON PAGE 2

INDICATES LOT NUMBER

75' FLOODWAY BUFFER INCLUDES:
50' ZONE-1 BUFFER &
25' ZONE-2 BUFFER

CUMBERLAND RIVER

BRILEY PARKWAY



BWSC
BARGE
WAGNER
SUMNER &
CANNON, INC.
ENGINEERS, ARCHITECTS PLANNERS
LANDSCAPE ARCHITECTS AND SURVEYORS
21 Commerce Street, Suite 600 Nashville, Tennessee 37203
PHONE (615) 251-6500 FAX (615) 251-0372

3189403/Exhibit/3189403_EXH-Tourism.dgn

2100400 CIVIL T... AUGUST 2007

SURVEYOR'S DESCRIPTION

Land in First Civil District, Fifteenth Councilmanic District, Nashville, Davidson County, Tennessee, being generally located in the southwest quadrant of Briley Parkway and McGavock Pike, and also being Lot Nos. 3, 4 on the Plat of First Revision (Unified Plat of Subdivision) GAYLORD ENTERTAINMENT COMPANY, according to the plat thereof as recorded under Instrument No. 20000502-0043734, also being Lot No. 2 on the Second Revision Unified Plat of Subdivision, GAYLORD ENTERTAINMENT COMPANY, of record in Instrument No. 20070417-0045714 and Parcel Nos. 128, 129, 130, 132, and 133 as shown on Davidson County Property Map No. 62, Registrar's Office for Davidson County, Tennessee, being more particularly described as follows:

BEGINNING at the northeast corner of Lot 3 on the above mentioned Plat and being a concrete monument on the westerly right-of-way line of Briley Parkway, (variable width right-of-way);

THENCE, with the westerly right-of-way of Briley Parkway the following calls:

- S 18° 22' 50" E, 303.04 feet to a concrete monument,
- S 22° 08' 42" E, 84.73 feet to an iron pin,
- S 15° 10' 54" E, 58.22 feet to an iron pin,
- S 10° 15' 16" E, 1,630.20 feet to an iron pin at the northeast corner of Lot 2 on the above mentioned plat;

THENCE; continuing with said westerly right-of-way of Briley Parkway the following calls:

- S 10° 15' 16" E, 30.60 feet to a point,
- S 79° 44' 43" W, 4.00 feet to a point,
- S 10° 17' 20" E, 313.67 feet to a point in the southerly line of Lot No. 2 of the above mentioned plat;

THENCE, with said southerly line the following calls:

- S 79° 42' 40" W, 993.24 feet to a point,
- S 13° 49' 48" W, 147.68 feet to a point,
- With a curve concave to the south, having a central angle of 39° 30' 04", a radius of 151.00 and a chord of N 77° 55' 14" W, 102.05 feet for an arc length of 104.10 feet to a point,
- With a curve concave to the northeast having a central angle of 87° 02' 54", a radius of 139.00 feet and a chord of N 54° 08' 50" W, 191.45 feet for an arc length of 211.18 feet to a point,
- N 10° 37' 23" W, 208.59 feet to a point,
- With a curve concave to the south, having a central angle of 89° 36' 27", a radius of 87.00 feet and a chord of N 55° 25' 36" W, 122.61 feet for an arc length of 136.06 feet to a point,
- S 79° 46' 10" W, 964.05 feet to a point on the low water line of the Cumberland River;

THENCE, with said low water mark the following calls:

- N 26° 28' 07" W, 850.24 feet to a point,
- N 35° 53' 11" W, 101.95 feet to a point,
- N 33° 23' 51" W, 1,547.39 feet to a point,
- N 34° 48' 25" W, 101.54 feet to a point,
- N 37° 02' 35" W, 486.69 feet to a point,
- S 82° 03' 02" E, 73.69 feet to a point in the southwest corner of Parcel 134 as conveyed to Opryland Attractions of record in Book 9899, page 635, R.O.D.C.;

(continued to right)

BWSC
BARBE WAGBONER & CANNON, INC.
 ENGINEERS ARCHITECTS PLANNERS
 LANDSCAPE ARCHITECTS AND SURVEYORS
 21 Commerce Street, Suite 600 Nashville, Tennessee 37203
 PHONE: (615) 259-6500 FAX: (615) 259-6572

3189403/Exhibits/3189403_EXH-Tourism.dgn

(cont.)

THENCE, continuing with said westerly line of Parcels 133 and 132 as conveyed to Opryland Attractions, N 28° 58' 23" W, 241.44 to a point in the northwesterly corner of Parcel 132;

THENCE, with said northerly line of Parcel 132, N 73° 42' 27" E, 301.83 feet to a point in the westerly right-of-way of Riverview Drive;

THENCE, with said westerly right-of-way of Riverview Drive, N 28° 02' 24" W, 100.00 feet to a point in the southeasterly corner of Parcel 130 as conveyed to Opryland Attractions of record in Book 9899, page 635, R.O.D.C.;

THENCE, leaving said right-of-way with the southerly line of Parcel 130, S 73° 46' 36" W, 300.00 feet to a point in the southwesterly line of Parcel 130;

THENCE, with said westerly line of Parcel 130, N 26° 58' 23" W, 268.00 feet to a point in the southwesterly corner of Parcel 128 as conveyed to Opryland Attractions of record in Book 10016, page 209, R.O.D.C.;

THENCE, with said Parcel 128 the following calls:

- N 28° 58' 23" W, 224.31 feet to a point,
- N 77° 33' 23" E, 194.38 feet to a point,
- S 87° 05' 30" E, 106.74 feet to a point,
- S 04° 52' 36" E, 11.46 feet to a point,
- S 21° 38' 21" E, 33.62 feet to a point,
- S 88° 17' 39" E, 105.04 feet to a point in the westerly right-of-way of Riverside Drive;

THENCE, with said westerly right-of-way the following calls:

- S 05° 47' 24" E, 203.93 feet to a point,
- S 28° 02' 24" E, 429.53 feet to a point;

THENCE, leaving said westerly right-of-way, N 61° 57' 38" E, 50.00 feet to a point in the easterly right-of-way of Riverside Drive;

THENCE, with said easterly right-of-way the following calls:

- N 28° 02' 24" W, 419.69 feet to a point,
- N 05° 47' 24" W, 185.04 feet to a point in the southerly right-of-way of McGavock Pike;

THENCE, with said southerly right-of-way the following calls:

- S 85° 31' 29" E, 856.78 feet to an iron pin,
- S 84° 10' 55" E, 1,275.68 feet to an iron pin,
- S 83° 22' 22" E, 311.89 feet to an iron pin on the northerly line of said Lot 4 on the above mentioned Plat;

THENCE, continuing with said right-of-way line the following calls:

- S 83° 00' 45" E, 469.17 feet to a point,
- S 62° 16' 45" E, 113.63 feet to a point,
- S 01° 39' 29" W, 148.80 feet to a point,
- S 43° 20' 31" E, 25.00 feet to a point,
- S 46° 39' 28" W, 25.00 feet to a point,
- S 01° 39' 29" W, 286.99 feet to a concrete monument,
- S 82° 18' 07" E, 148.28 feet to a concrete monument,
- S 79° 18' 57" E, 248.99 feet to the point of beginning.

Containing 9,417,996 square feet or 216.21 Acres, more or less. □

06-12-07

EXHIBIT:

TOURISM

DEVELOPMENT ZONE

PG.2

AS PART OF

**GAYLORD OPRYLAND RESORT
AND CONVENTION CENTER**